

The print-out is not subject to the modification service.

Intended for internal and supplier use

EN

Ⓐ piston rod processing per STAB-Spec. 10028959, table 1

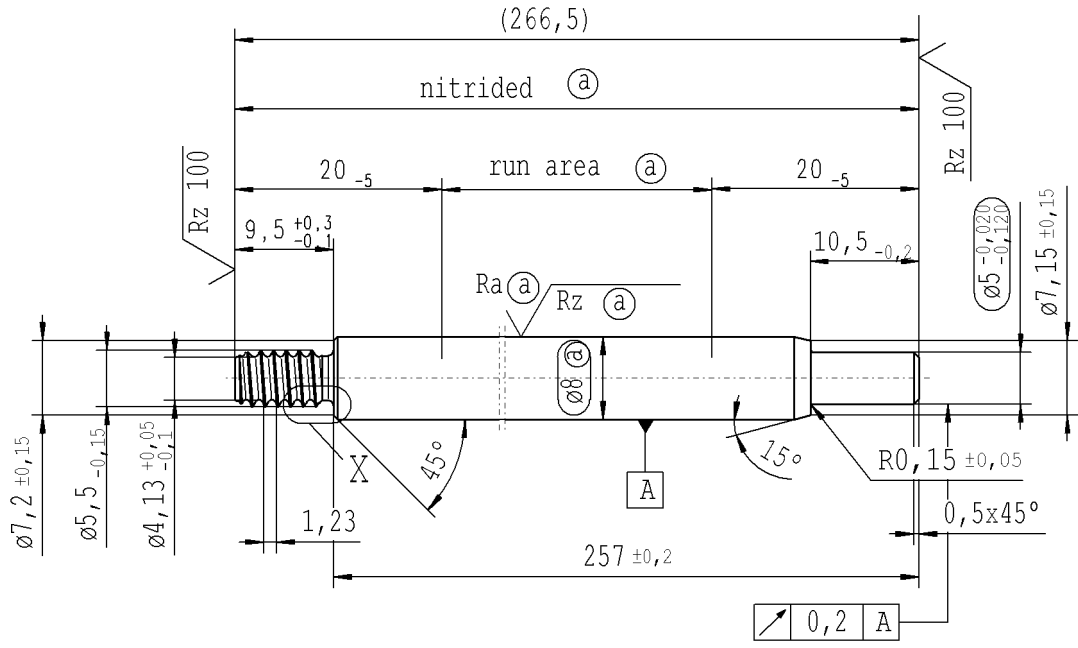

pre-worked:

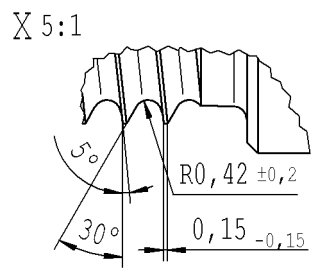
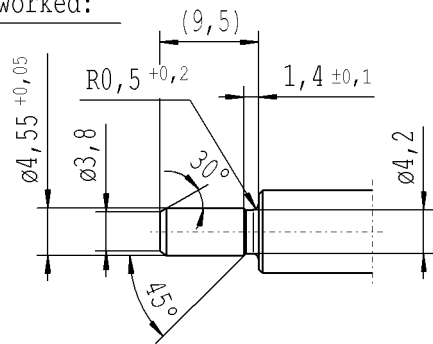

$\sqrt{Rz\ 25}$  (  $\sqrt{Rz\ 100}$   $Ra\ \text{Ⓐ}$   $Rz\ \text{Ⓐ}$  )  $\swarrow +0,2$   $\searrow -0,2$

**RELEASE**  
 for supplier  
 company Zhang Shi

Environmental protection acc. to STAB-Spec. 10005649

DE: X	EN: X	ES:	IT:	PR:	FR:	RO:	CAD created document; handwritten changes not permitted		Material:	All dimensions are in mm		Identification of important characteristics		Date	Name
new	INITIAL RELEASE	hardness	9,5 <sup>+0,3</sup> <sub>-0,1</sub>	0,15	R0,42±0,2	run area		1.1193	S45C JISG 4051		Dimensions without tolerances		13.12.2007	Höfer	
old	-	-	9,5±0,1	0,38	R1,26	hardness		Edge tolerances acc. to DIN ISO 13715	Scale: (Original DIN A3) 2:1		DIN ISO 2768-mK		23.07.2010	B.Klinkner	
Field	-	E2-6		B/C2-3	E 4/5			Surface finish	DIN EN ISO 1302		We reserve all rights to this document, to any patents or patent registrations related hereto, and to the duplication, retransmission by third parties and misc. use. Any use of this document is not permitted without the written consent of STABILUS.		Document No.:		
Date/Name	13.12.2007 Höfer	28.02.2008 Donat	23.7.10 Keßelh.					Replaces:					10151066		
Chg. No.	-	564069	581803										Material No.:		
Rev.	0	1	2						<b>STABILUS</b>		PISTON ROD		005644		