

③ piston rod processing per STAB-Spec. 10028959, table 1

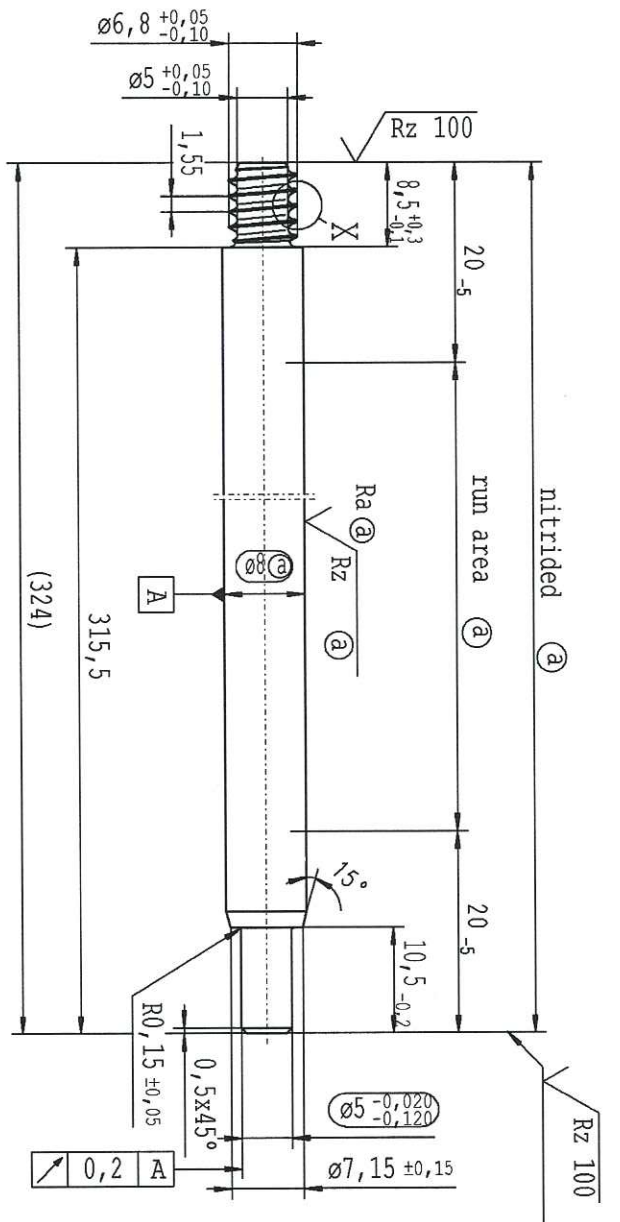

RELEASE  
for supplier  
company Zhang Shi

pre-worked:

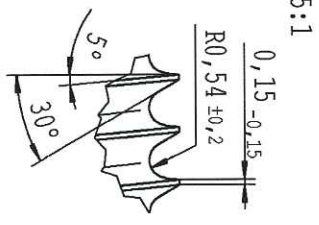
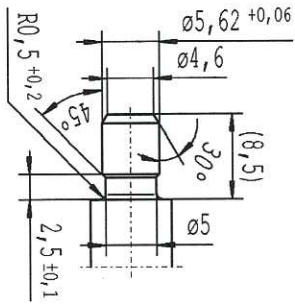

$\sqrt{Rz\ 25}$   $\sqrt{Rz\ 100}$   $Ra\ (a)$   $Rz\ (a)$   $\sqrt{+0,2}$   $\sqrt{-0,2}$

CAD created document; handwritten changes not permitted

Environmental protection acc. to STAB-Spec. 10005649

DE: X	EN: X	ES:	IT:	PR:	FR:	RO:	Material: 1.1193 S45C JISG 4051	All dimensions are in mm	Identification of important characteristics	Date	Name
new	INITIAL RELEASE							Scale: (Original DIN A3) 2:1	Dimensions without tolerances	18.04.2011	K.Martx
old							Edge tolerances acc. to DIN ISO 13715				
Field							Surface finish: DIN EN ISO 1302			Document No.: 10151065	
Date/Name	18.04.2011 K.Martx						Replaces:			Material No.: 988987	
Orig. No.	588217										
Rev.	0										

Ident. Doc.:

STABILUS

PISTON ROD