

The print-out is not subject to the modification service.

Intended for internal and supplier use

EN

Ⓐ piston rod processing per STAB-Spec. 10028959, table 1

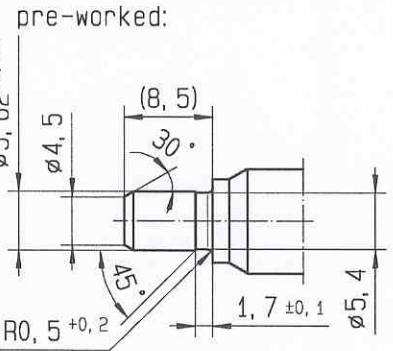
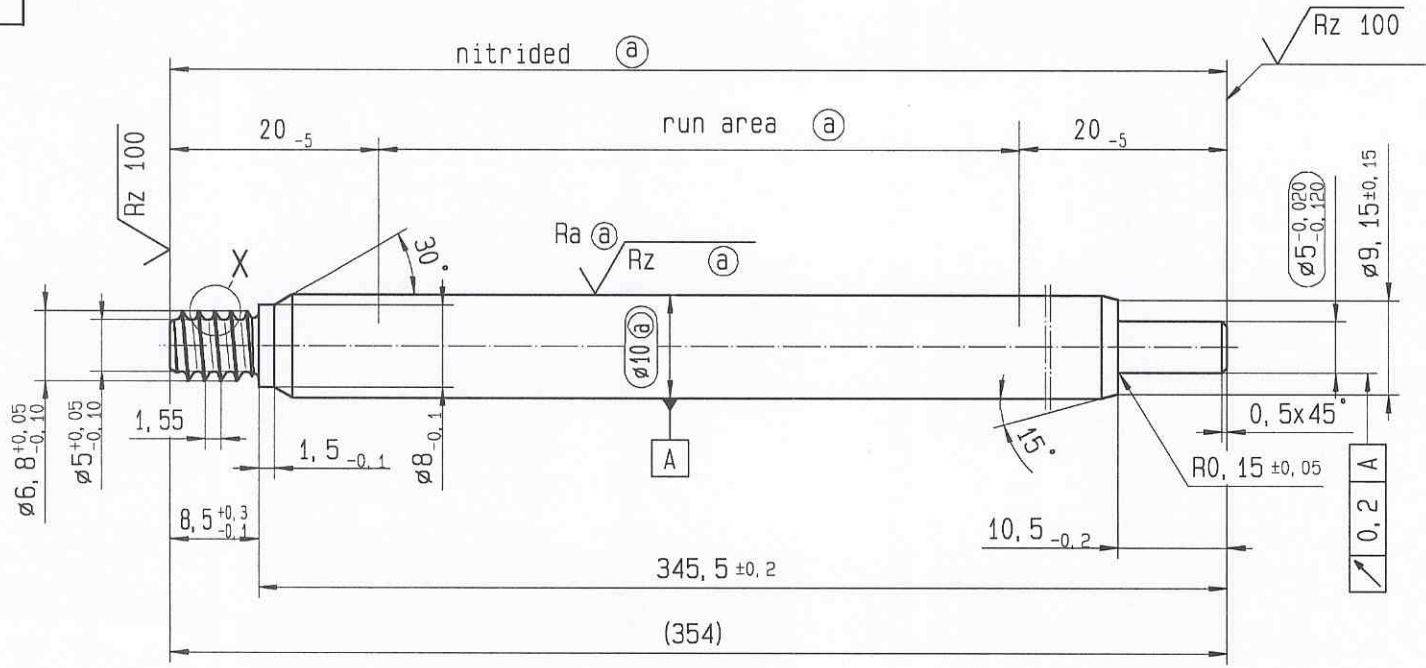

X 5: 1

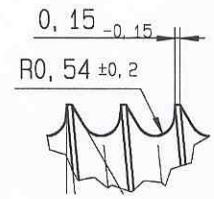

$\sqrt{Rz\ 25}$  (  $\sqrt{Rz\ 100}$   $Ra\ \text{Ⓐ}$   $Rz\ \text{Ⓐ}$  )  $\swarrow +0,2$   $\searrow -0,2$

**RELEASE**  
 for supplier  
 company ZhangShi  
 22.01.2015 / *Schulz A.*  
 (date / signature)

Ident. Doc.: L41

AIAG CQI-standards acc. to STAB-Spec. 10027692							Environmental protection acc. to STAB-Spec. 10005649					
DE: X	EN: X	ES:	IT:	PR:	FR:	RO:	CAD created document; handwritten changes not permitted	Material: 1.1193	All dimensions are in mm	Identification of important characteristics	Date	Name
new	INITIAL RELEASE							S45C JISG 4051	Scale: (Original DIN A3) 2: 1	Dimensions without tolerances DIN ISO 2768 mK	Drawn by 21.01.2015	Kron
old	-							Edge tolerances acc. to DIN ISO 13715			Checked 22.01.2015	<i>Schulz A.</i>
Field	-							Surface finish DIN EN ISO 1302	We reserve all rights to this document, to any patents or patent registrations related hereto, and to the duplication, retransmission by third parties and misc. use. Any use of this document is not permitted without the written consent of STABILUS.			
Date/Name	21.01.2015 Kron							Replaces:	Document No.: 10151520			
Chg. No.	620485								Material No.: 908937			
Rev.	0							<b>STABILUS</b>	<b>PISTON ROD</b>			