

CONFIDENTIAL!
Intended for internal use only

EN

Bretel datum: 4/2/2016 - 6:56

Ident. Doc.:

supp. No.	material no.			A	E	F
	surface treatment processing acc. to STAB-Spec.			overall length	length without endfitting stud	version
	10006248 Tab. IV	10006248 Tab. X	10028959 Tab. I China pay part			
3	016362		016362	180	172	1
4	020901		020901	165	157	1
5	032882		032882	161	153	1
6	032884		032884	140	132	1
7	032885		032885	191	183	1
8	763639		763639	200	192	1
9	834119		834119	129	121	1
10	424474		424474	144	136	1
11	480400		480400	128	120	1
12	123101		123101	189	181	1
13	276785		276785	120	112	1
14	439307		439307	102	94	1
15	451257		451257	201	193	1
16	451496		451496	300	292	1
17	451735		451735	402	394	1
18	268900		268900	99	91	1
19	269856		269856	159	151	1
20	333908		333908	101	93	1
21	084632		084632	195	187	1
22	394375		394375	126	118	1
23	115702		115702	225	217	1

DE:	EN:	ES:	IT:	PR:	FR:	RO:	CAD created document handwritten changes not permitted	
new	INITIAL RELEASE		Tol. thread	text: product family ...	80-200	R1 alternative 0,5x450	Table X completed	approved lengths: 80-600mm
old	-	-	-	- dimension B	80-150	0,5x450	-	approved lengths: 80-200mm
Field	-	-	-	B/C 2/3 A-F 7/8	B3	E/1	A-F/7-8	E/3-4
Date/Name	07.12.2007 H?fer	14.01.08 H?	09.05.2008 Hein	25.07.08 H?	29.04.2009 Hein	06.07.2010 Hein	24.11.2015 Hein	
Chg. No.	-	562504	564472	566931	572540	581328	630576	
Rev.	0	1	2	3	4	5	6	

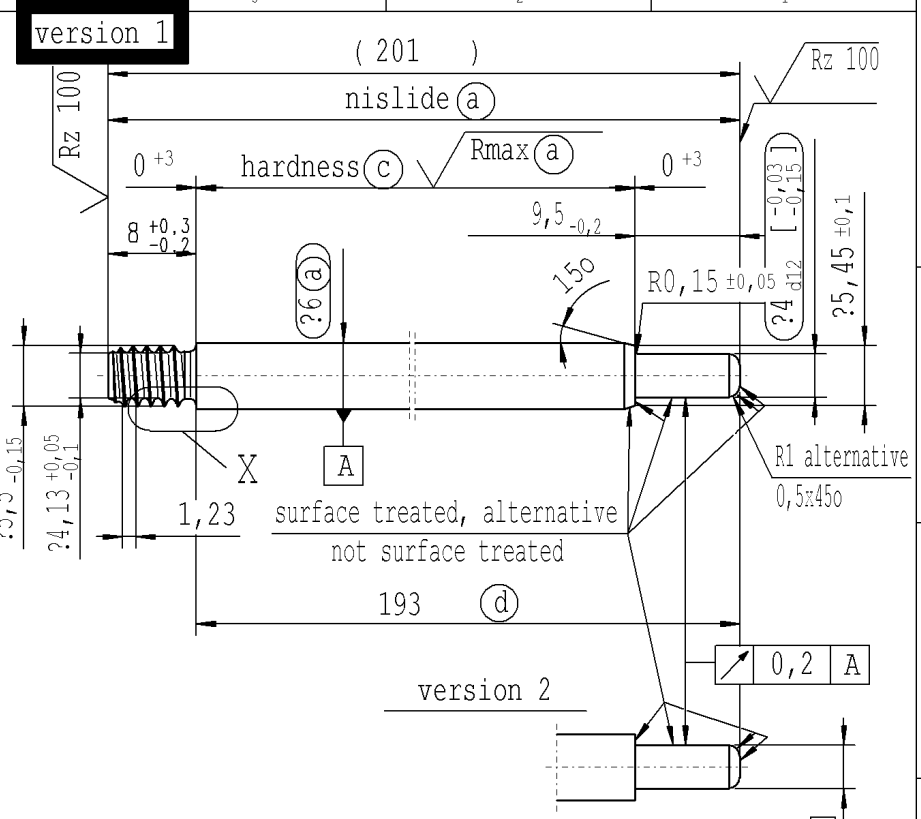
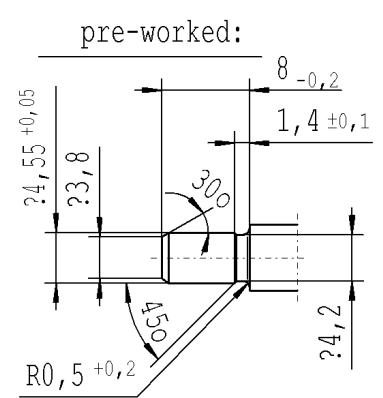
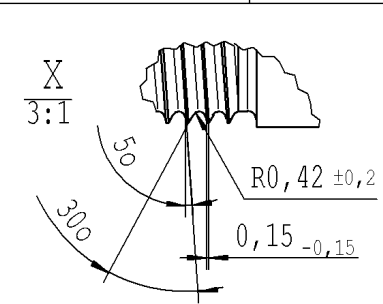

Production Stabilus

(a) piston rod processing acc. to STAB-Spec. 10006248

(c) RHT 0,4..0,7 mm before grinding, > 68 HRA (acc. to DIN ISO 6508)

(d) tolerances: $\begin{matrix} +0,2 \\ -0,1 \end{matrix}$ after turning
 $\begin{matrix} +0,2 \\ -0,2 \end{matrix}$ after straightening
 $\begin{matrix} +0,2 \\ -0,2 \end{matrix}$ after nisliding

for pay part China product family: 2008/0130 approved lengths: 80-600 mm

Pay part China acc separate Supplier-drawing

$\sqrt{Rz\ 25}$ ($\sqrt{Rz\ 100}$ $\sqrt{Rmax\ (a)}$)

sheet 1 of 1

Environmental protection acc. to STAB-Spec. 10005649

DE:	EN:	ES:	IT:	PR:	FR:	RO:	CAD created document handwritten changes not permitted		Material:	All dimensions are in mm	Identification of important characteristics	Date	Name
new	INITIAL RELEASE		Tol. thread	text: product family ...	80-200	R1 alternative 0,5x450	Table X completed	approved lengths: 80-600mm	mat.no. 010707	Scale: (Original DIN A3) 2:1	Dimensions without tolerances DIN ISO 2768 mK	Drawn by	07.12.2007 H?fer
old	-	-	-	- dimension B	80-150	0,5x450	-	approved lengths: 80-200mm	Edges tolerances acc. to DIN ISO 13715			Checked	25.11.2015 Klinkner
Field	-	-	-	B/C 2/3 A-F 7/8	B3	E/1	A-F/7-8	E/3-4	Surface finish DIN EN ISO 1302			Document No.:	10151336
Date/Name	07.12.2007 H?fer	14.01.08 H?	09.05.2008 Hein	25.07.08 H?	29.04.2009 Hein	06.07.2010 Hein	24.11.2015 Hein		Replaces:			Material No.:	
Chg. No.	-	562504	564472	566931	572540	581328	630576		STABILUS	PISTON ROD			
Rev.	0	1	2	3	4	5	6						