

Ident. Doc.: SN 2663C@-surface : 12/10/2016 - 9:36

The print-out is not subject to the modification service.

Intended for internal and supplier use

supp No.	material no.				KOST without surface treatment	overall length	stud length piston side	length without endfitting stud	version	only tab. IV allowable
	table IV Nislide black for STUS / STM acc. STAB-Spec. 10210309	table V Nislide light	table VIII Nislide black polished	table X Nislide "G"						
769	787989			787989	216.0	11	207.5	1		
770	809738			809738	528.0	16	519.5	2		
772				172087	129.0	10.5	120.5	1		
774	437855			437855	287.5	10.5	279.0	1		
776	446459			446459	138.5	10.5	130.0	1		
777	814991			814991	233.0	10.5	224.5	1		
779	108514				141.0	10.5	132.5	1	x	
780		548991			219.0	10.5	210.5	1		
781	705297				216.0	10.5	207.5	1	x	
782				753814	291.0	10.5	282.5	1		
783	864710			864710	225.0	11	216.5	1		
784				074099	183.0	10.5	174.5	1		
785				151057	321.0	10.5	312.5	1		
786	186668			186668	384.0	22.5	375.5	2		
789	816194			816194	172.0	10.5	163.5	1		
790				894825	303.0	10.5	294.5	1		
791	774845			774845	223.5	16.5	215.0	2		

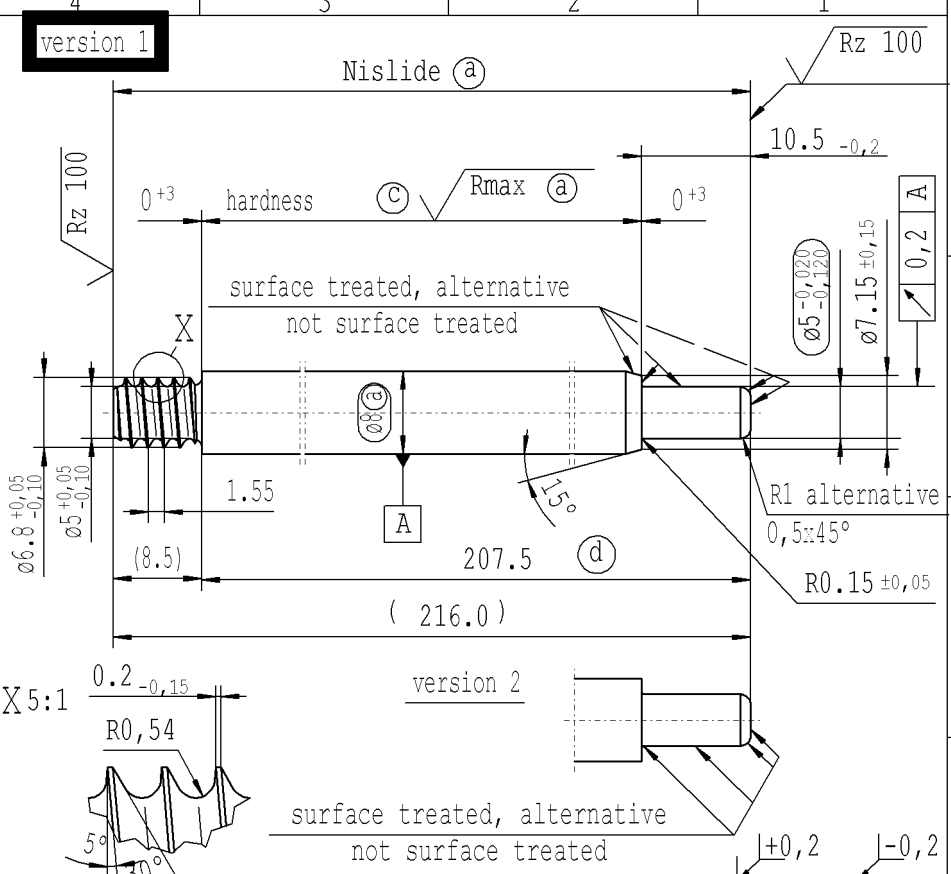

(a) piston rod processing acc. STAB-Spec. 10006248 for piston rods without surface treatment  
 grinding dimension  $-0,046$  /  $-0,057$   
 $R_{max}$  after grinding  $\leq 1,5 \mu m$

(c) RHT 0,4..0,7 mm before grinding,  $> 68$  HRA (acc. to DIN ISO 6508)

(d) tolerances:  $+0,2$  /  $-0,1$  after turning  
 $+0,3$  after straightening  
 $+0,3$  after nisliding

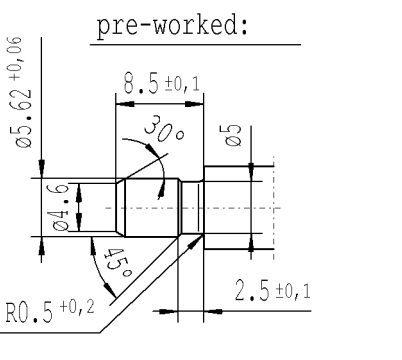

Temporary deviation approval: 008/14  
 Only apply to:  
 STAB STBS STAU STUS STMX STN STNE STNR STCN STRO  
 Caution!  
 Pos. 840 139592 acc. Tab.IV only

sheet 31  
 of 40

DE: X				EN: X				ES: X				IT: X				PR: X				FR: X				RO: X				Material: mat.no. 010731				All dimensions are in mm				Identification of important characteristics				Date: 08.11.1999				Name: Mohrs			
new				Supplier / KOST w/o surface				TED 008/14				-				1,5 $\mu m$				rom. version created				Edge tolerances acc. to DIN ISO 13715				Scale: (Original DIN A3) 2:1				Dimensions without tolerances DIN ISO 2768 mK				Checked: 20.04.2016				Milles							
old				internal /				-				TED 006/06				1,5 m				-				Surface finish DIN EN ISO 1302				We reserve all rights to this document, to any patents or patent registrations related hereto, and to the duplication, retransmission by third parties and misc. use. Any use of this document is not permitted without the written consent of STABILUS.				Document No.: 10001245				Material No.:											
Field				-				139592 Pos.840				-				B7				-				Replaces: Zchnng. gl. Nr. v. 17.12.1998				PISTON ROD																			
Date/Name				16.05.2014 Donat				17.06.2014 Höfer				22.07.2015 Höfer				26.01.2016 Höfer				20.04.2016 Jablonski				STABILUS																							
Chg. No.				613491				614261				626240				632853				636361																											
Rev.				74				75				76				77				78																											

UNCONTROLLED DOCUMENT - VALID ON 2016-10-13 / PN: 705297