

Ident. Doc.: SN 2663C@-surface : 12/10/2016 - 9:36

supp No.	material no.				KOST without surface treatment	overall length	stud length piston side	length without endfitting stud	version	only tab. IV allowable
	table IV Nislide black for STUS / STM acc. STAB-Spec. 10210309	table V Nislide light	table VIII Nislide black polished	table X Nislide "G"						
45	3174FW			3174FW	109.0	10.5	100.5	1		
46	3179FY				180.0	10.5	171.5	1	x	
48	3214FY			3214FY	130.5	10.5	122.0	1		
49	3223FX		2637SG	3223FX	108.0	10.5	99.5	1		
53			2736QM		411.0	10.5	402.5	1		
54	3355FP			3355FP	111.0	10.5	102.5	1		
59	3431FN		2124MF	3431FN	333.0	10.5	324.5	1		
60	3438FF			3438FF	195.0	10.5	186.5	1		
63	3551FV		2615SB	3551FV	126.0	10.5	117.5	1		
65	3593FO			3593FO	315.0	10.5	306.5	1		
66			2629SC		129.0	10.5	120.5	1		
67	3732FO			3732FO	345.0	10.5	336.5	1		
68	3768FU			3768FU	291.0	10.5	282.5	1		
69	3792FF			3792FF	255.0	10.5	246.5	1		
70	3794FW		2123MK	3794FW	312.0	10.5	303.5	1		
71	3821FS			3821FS	306.0	10.5	297.5	1		
73			4451LX		282.0	10.5	273.5	1		

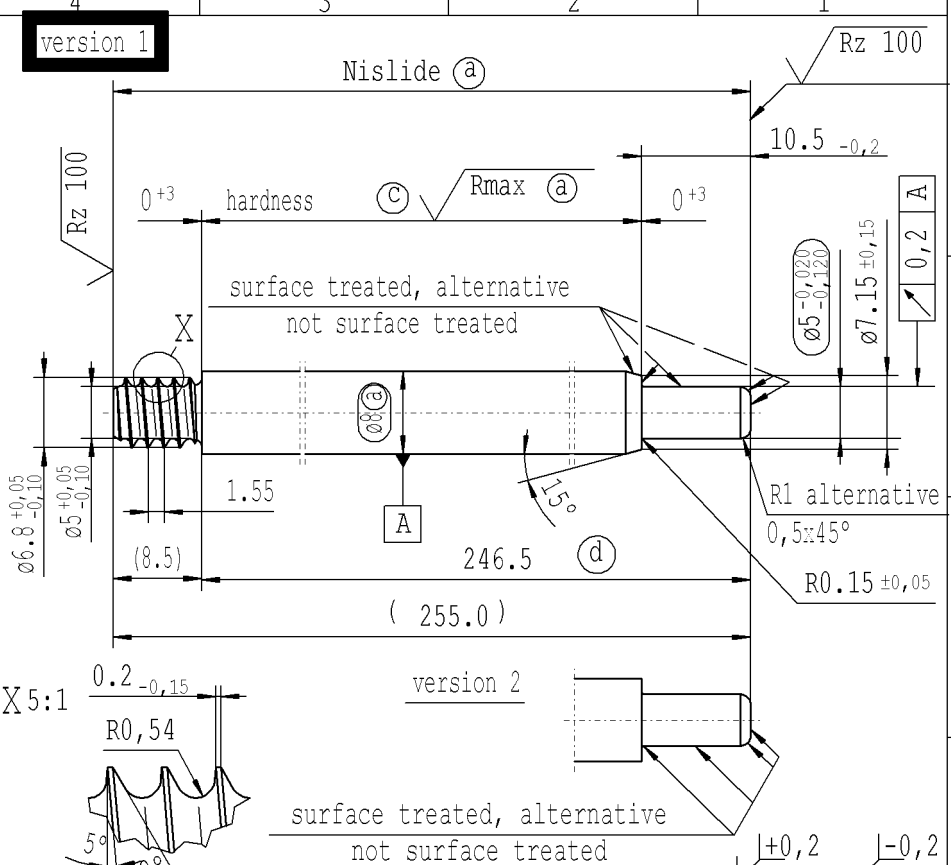

(a) piston rod processing acc. STAB-Spec. 10006248 for piston rods without surface treatment  
 grinding dimension  $-0,046$  /  $-0,057$   
 $R_{max}$  after grinding  $\leq 1,5 \mu m$

(c) RHT 0,4..0,7 mm before grinding,  $> 68$  HRA (acc. to DIN ISO 6508)

(d) tolerances:  $+0,2$  /  $-0,1$  after turning  
 $+0,3$  after straightening  
 $+0,3$  after nisliding

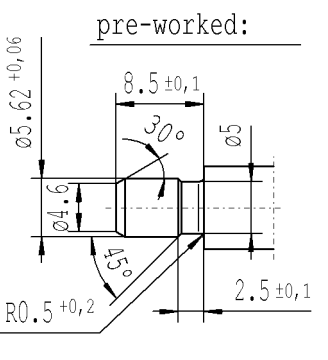

$\sqrt{Rz 25}$  ( $\sqrt{Rz 100}$   $\sqrt{R_{max} (a)}$ )  
 \* CUSTOMER DRAWING AVAILABLE

Temporary deviation approval: 008/14  
 Only apply to  

STAB	STBS	STAU	STUS	STMX	STBR	STNE	STBR	STCN	STRO
------	------	------	------	------	------	------	------	------	------

 Caution!  
 Pos. 840 139592 acc. Tab.IV only

sheet 3  
 of 40

AIAG CQI-standards acc. to STAB-Spec. 10027692						Environmental protection acc. to STAB-Spec. 10005649							
DE: X	EN: X	ES: X	IT:	PR: X	FR:	RO: X	Material: mat.no. 010731						
new	Supplier / KOST w/o surface	TED 008/14		-	1,5 $\mu m$	rom. version created	All dimensions are in mm		Identification of important characteristics		Drawn by	Date	Name
old	internal / -	-		TED 006/06	1,5 m	-	Scale: (Original DIN A3) 2:1		Dimensions without tolerances DIN ISO 2768 mK		Checked	08.11.1999	Mohrs
Field	-	139592 Pos.840		-	B7	-	We reserve all rights to this document, to any patents or patent registrations related hereto, and to the duplication, retransmission by third parties and misc. use. Any use of this document is not permitted without the written consent of STABILUS.		Document No.:		10001245		
Date/Name	16.05.2014 Donat	17.06.2014 Höfer	22.07.2015 Höfer	26.01.2016 Höfer	20.04.2016 Jablonski	Replaces: Zchnng. gl. Nr. v. 17.12.1998		Material No.:					
Chg. No.	613491	614261	626240	632853	636361	<b>STABILUS</b>		PISTON ROD					
Rev.	74	75	76	77	78								

UNCONTROLLED DOCUMENT - VALID ON 2016-10-13 / PN: 3792FF