

The print-out is not subject to the modification service.

Intended for internal and supplier use

EN

B

A

Ident. Doc.: L63

ⓐ piston rod processing per STAB-Spec. 10028959, table 1

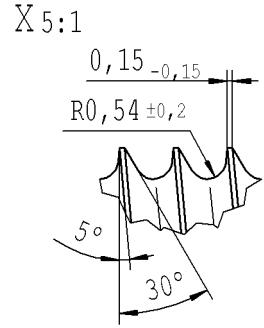
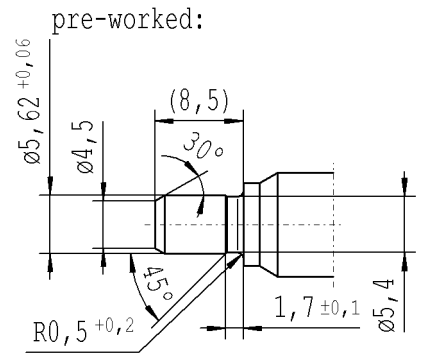
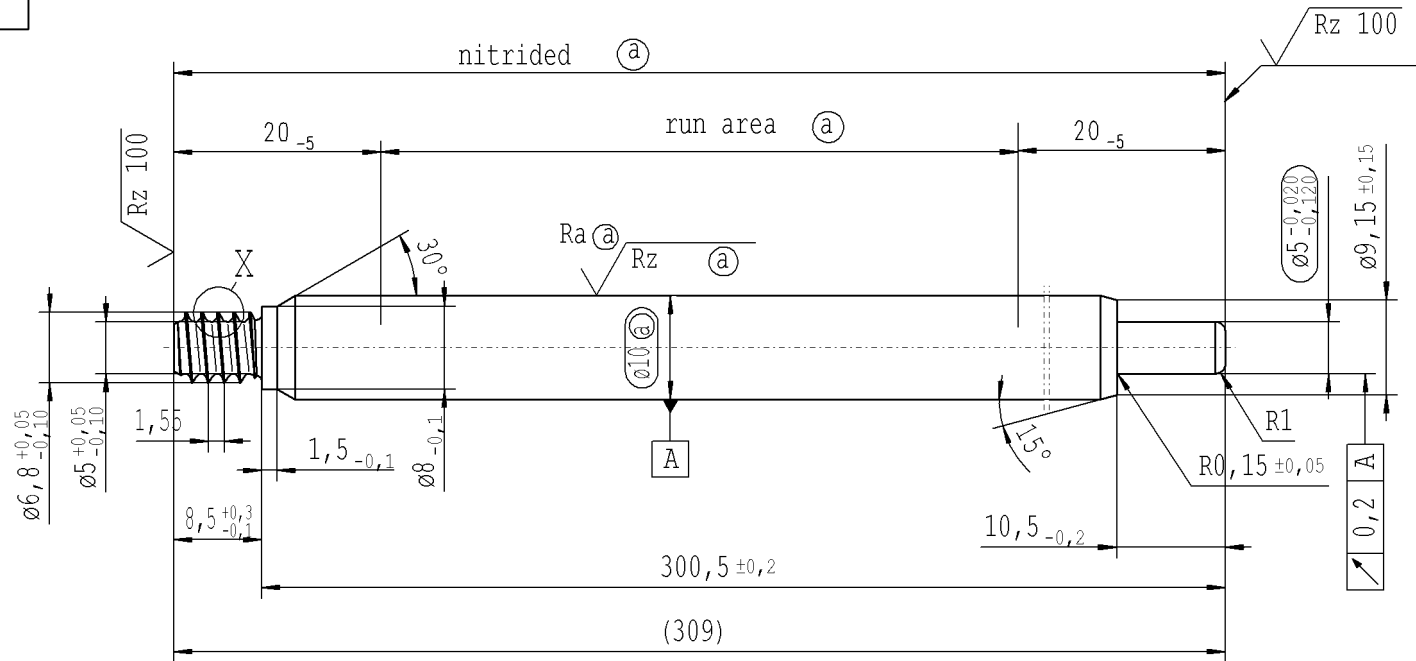

$\sqrt{Rz\ 25}$ ($\sqrt{Rz\ 100}$ $Ra\ \textcircled{a}$ $Rz\ \textcircled{a}$) $\begin{matrix} \swarrow +0,2 \\ \searrow -0,2 \end{matrix}$

AIAG CQI-standards acc. to STAB-Spec. 10027692

Environmental protection acc. to STAB-Spec. 10005649

DE: X	EN: X	ES:	IT:	PR:	FR:	RO:	CRD created document; handwritten changes not permitted
new	INITIAL RELEASE						
old	-						
Field	-						
Date/Name	02.11.2016 Höfer						
Chg. No.	647129						
Rev.	0						

RELEASE
for supplier
company ZhangShi
Dat. 02.11.2016 Schilz A.
(date / signature)

Material: 1.1193
S45C JISG 4051
Edge tolerances acc. to DIN ISO 13715
Surface finish DIN EN ISO 1302
Replaces:
STABILUS

All dimensions are in mm
Scale: (Original DIN A3) **2:1**
We reserve all rights to this document, to any patents or patent registrations related hereto, and to the duplication, retransmission by third parties and misc. use. Any use of this document is not permitted without the written consent of STABILUS.

PISTON ROD

Identification of important characteristics	Date	Name
Dimensions without tolerances DIN ISO 2768 mK	02.11.2016	Höfer
Document No.:	02.11.2016	Milles
10151520		
Material No.:		
403699		