

The print-out is not subject to the modification service.

Intended for internal and supplier use

EN

Ⓐ piston rod processing per STAB-Spec. 10028959, table 1

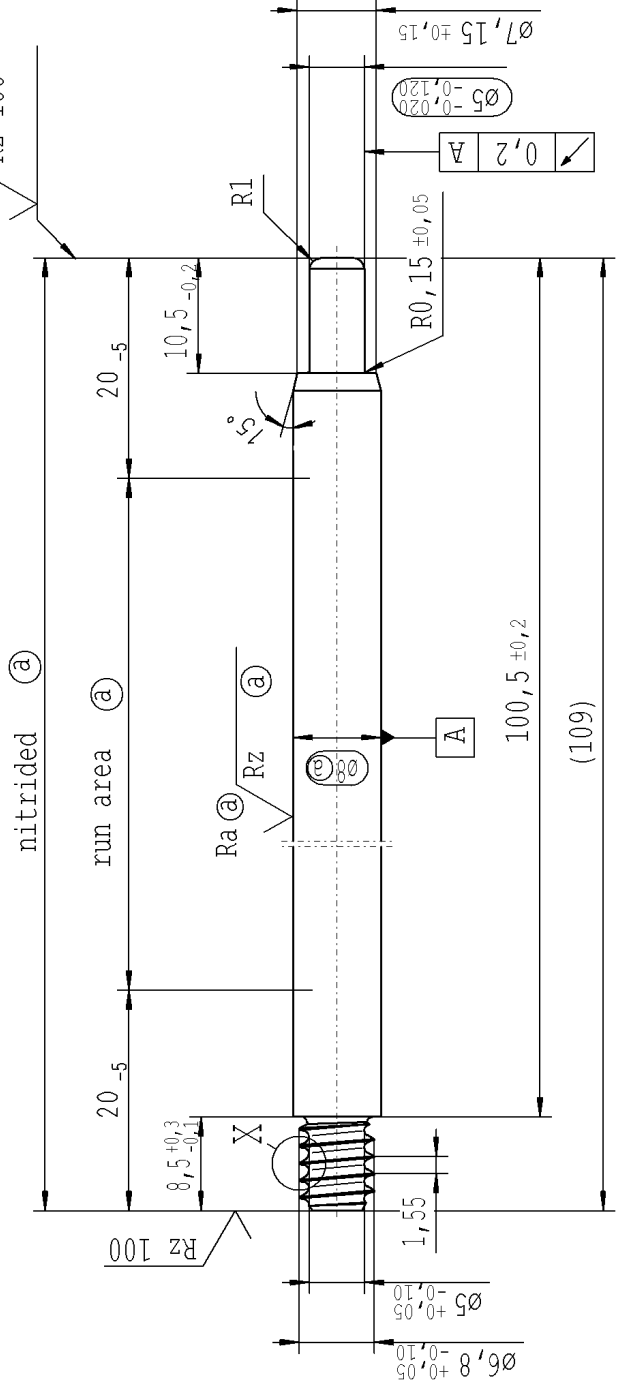

X 5:1

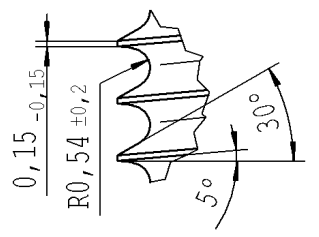

pre-worked:

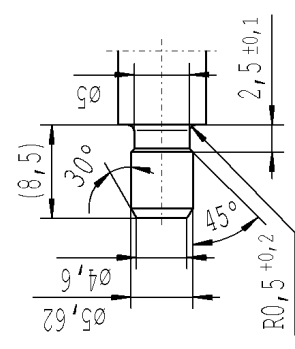

$\sqrt{Rz\ 25}$ ($\sqrt{Rz\ 100}$ $\sqrt{Ra\ \text{Ⓐ}}$ $\sqrt{Rz\ \text{Ⓐ}}$) \downarrow $\begin{matrix} +0,2 \\ -0,2 \end{matrix}$

DE: X EN: X ES: IT: PR: FR: RO:		AIAG CQI-standards acc. to STAB-Spec. 10027692		Environmental protection acc. to STAB-Spec. 10005649	
CAD created document; handwritten changes not permitted		Material: 1.1193 S45C JUSG 4051 annealing		All dimensions are in mm	
INITIAL RELEASE		Edge tolerances acc. to DIN ISO 13715		Scale: (Original DIN A3) 2:1	
Date/Name 21.01.2016 Höfer		Surface finish DIN EN ISO 1302		Dimensions without tolerances DIN ISO 2768-mK	
Chg. No. 632804		Replaces:		We reserve all rights to this document, to any patents or patent registrations related hereto, and to the duplication, retransmission by third parties and misc. use. Any use of this document is not permitted without the written consent of STABILUS.	
Rev. 0		company Zhang Shi		Document No.: 10151065	
0		Dat. 21.01.2016 Schütz A. (date / signature)		Material No.: 343707	
0		STABILUS		PISTON ROD	

Ident., Doc.: L221

***** Druckdatum: 1/21/2016 / 3:49:10 PM ***** Ausdruck nicht masszetzen *****