

Ⓐ piston rod processing per STAB-Spec. 10028959, table 1

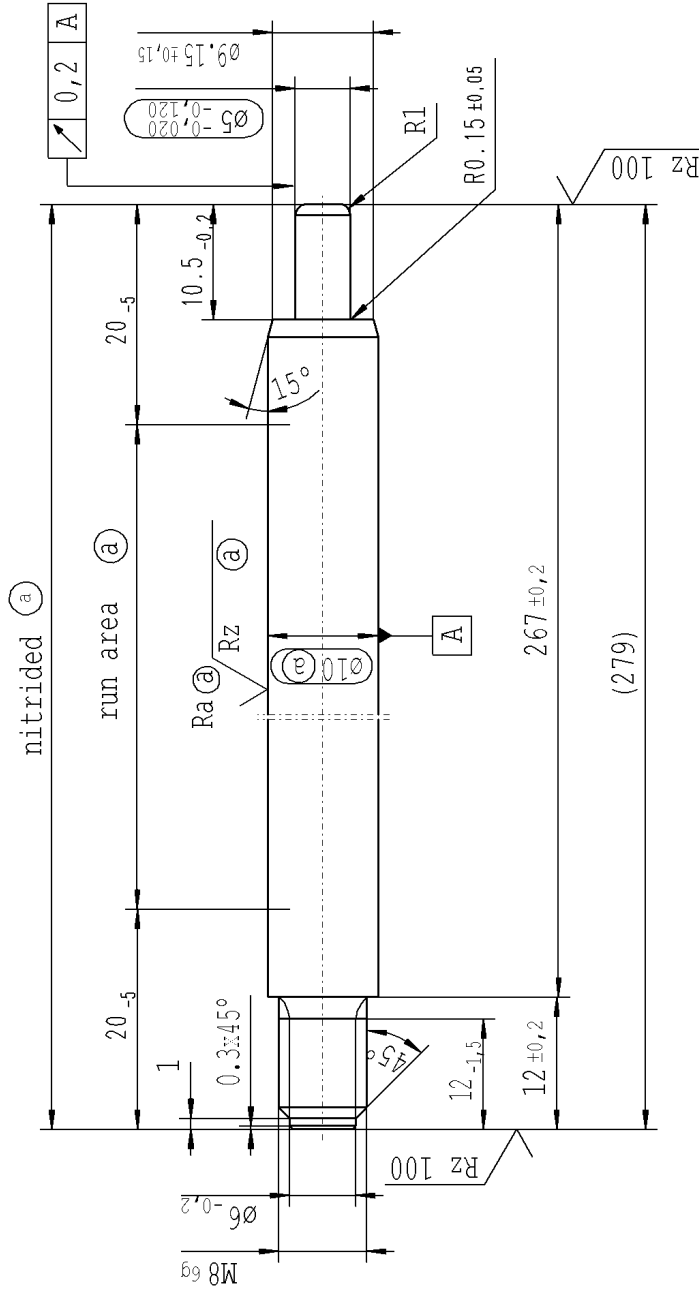

thread tolerances acc. to DIN ISO 965-3

$$\sqrt{Rz\ 25} \left(\sqrt{Rz\ 100} \right) \sqrt{Rz\ \text{Ⓐ}} \sqrt{Rz\ \text{Ⓐ}} \sqrt{+0,2} \sqrt{-0,2}$$

Environmental protection acc. to STAB-Spec. 10005649		Identification of important characteristics		Date		Name	
All dimensions are in mm		Dimensions without tolerances		11.05.2016		Höfer	
Scale: (Original DIN A3)		2:1		Checked		11.05.2016	
We reserve all rights to this document, to any patents or patent registrations related hereto, and to the duplication, retransmission by third parties and misc. use. Any use of this document is not permitted without the written consent of STABILUS.		DIN ISO 2768-mK		Document No.:		10166619	
Material: 1.1193		S45C JISG 4051		Material No.:		121200	
Edge tolerances acc. to DIN ISO 13715		Surface finish DIN EN ISO 1302		PISTON ROD			
Replaces:				STABILUS			
Material: 1.1193		S45C JISG 4051		Date: 11.05.2016		Schilz A.	
Edge tolerances acc. to DIN ISO 13715		Surface finish DIN EN ISO 1302		company		Zhang Shi	
Replaces:				(date / signature)			
AIAG CQI-standards acc. to STAB-Spec. 10027692		CAD created document; handwritten changes not permitted		INITIAL RELEASE		637974	
Material: 1.1193		S45C JISG 4051		Date/Name		11.05.2016 Höfer	
Edge tolerances acc. to DIN ISO 13715		Surface finish DIN EN ISO 1302		Chg. No.		0	
Replaces:				Rev.			