

① piston rod processing per STAB-Spec. 10028959, Table 1

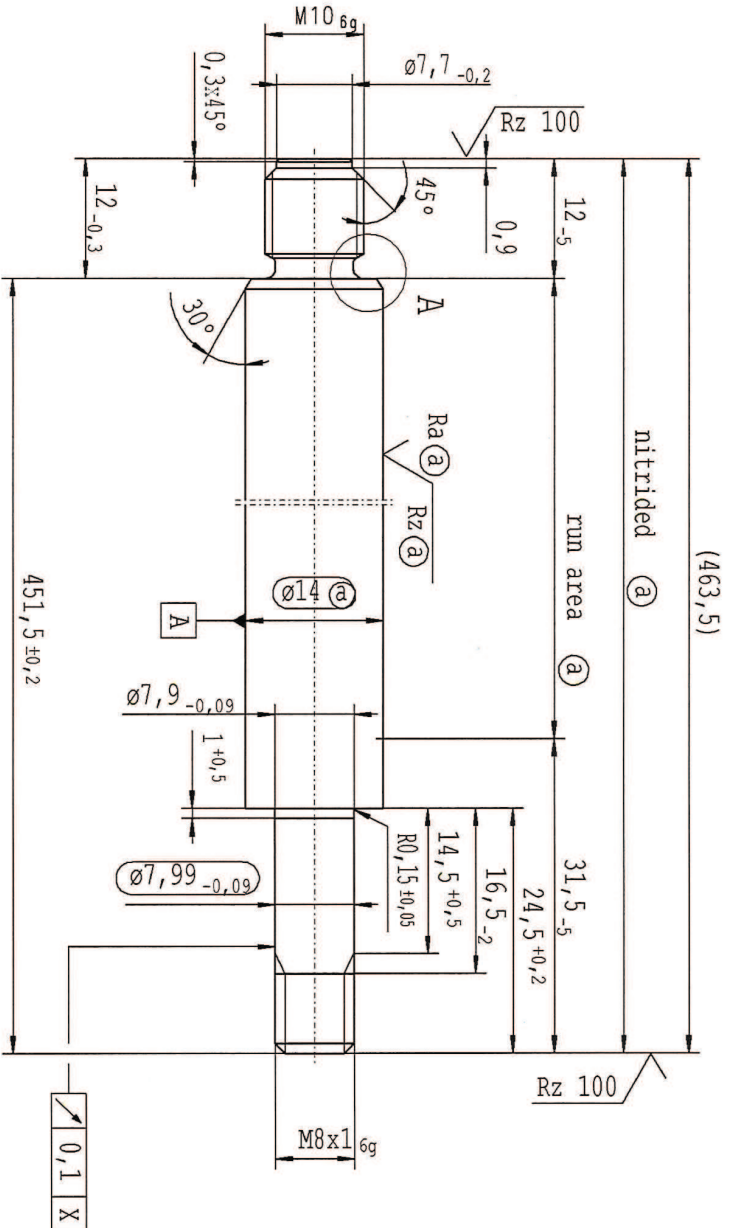
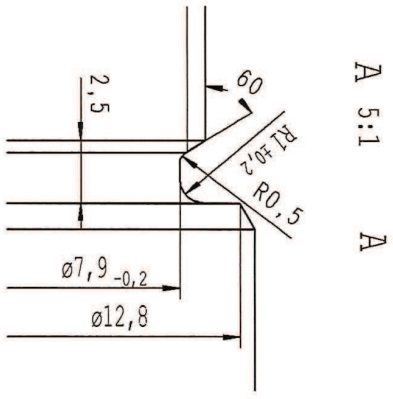

thread tolerances acc. to DIN ISO 965-3

$\sqrt{Rz\ 25}$ ($\sqrt{Rz\ 100}$ Ra ① Rz ①) $\sqrt{+0,2}$ $\sqrt{-0,2}$

AIAG CQI-standards acc. to STAB-Spec. 10027692

CAD created document; handwritten changes not permitted

DE: X	EN: X	ES:	IT:	PR:	FR:	RO:	Material: 1.1193			All dimensions are in mm			Date		Name		
INITIAL RELEASE							S45C JISG 4051			Scale: 2:1		Drawn by		Date		Name	
Field							Edge tolerances acc. to DIN ISO 13715			Surface finish		DIN EN ISO 1302		07.11.2017		Höfer	
Date/Name	07.11.2017 Höfer						Replaces:			DIN ISO 2768-mS		10249898		07.11.2017		KIMMER	
Chg. No.	663156						STABILUS			PISTON ROD		656088					
Rev.	0						RELEASE FOR SUPPLIER company Zhang Shi			Date: 07.11.2017							

RELEASE FOR SUPPLIER
company Zhang Shi
Date: 07.11.2017

STABILUS

PISTON ROD

Material No.: 656088