

Piston rod processing similar to
STAB-Spec. 10006248 table IV

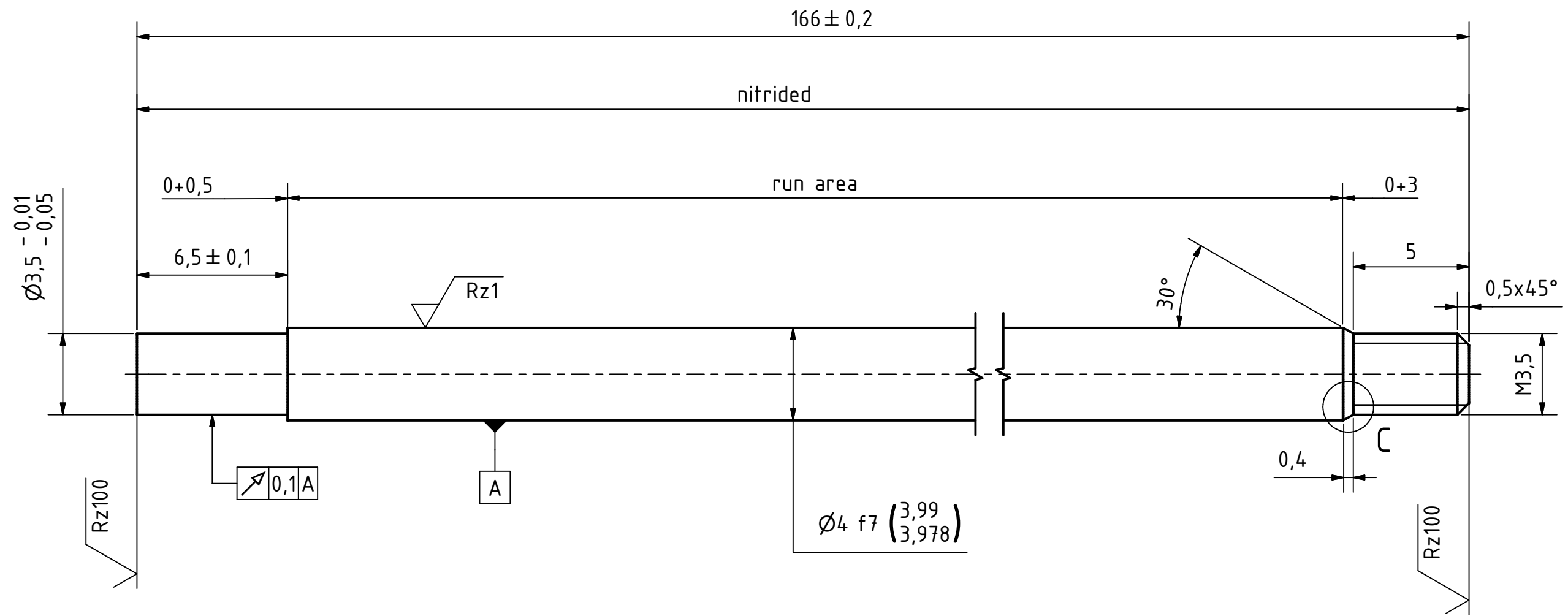

C (20 : 1)

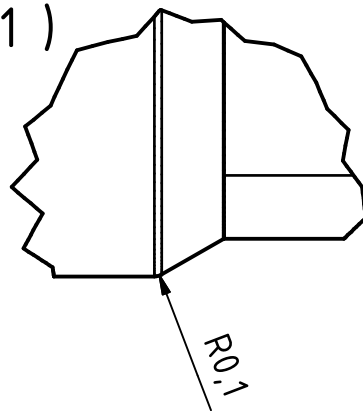

$\sqrt{Rz25}$ (✓)

$-0,20$
 $-0,05$ $+0,40$
 $+0,05$

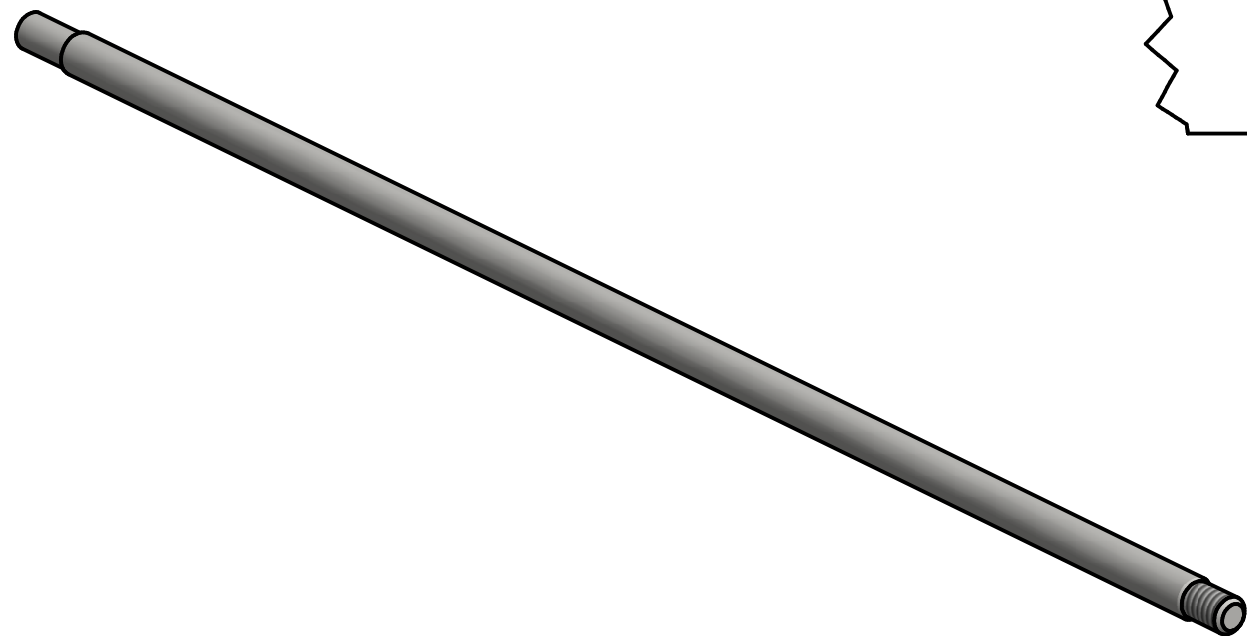

We reserve all rights to this document, to any patents or patent registrations related hereto, any to the duplication, retransmission by third parties and misc. use. Any use of this document is not permitted without the written consent of HAHN-Gasfedern.				General-tolerance ISO 2768-m	Edge-tolerances DIN 6784	Sc. 5:1	Art.-Nr.:	Wrought mat.: S45C
				Date	Name	Material:		
				Drawn by	UGneiting	Weight:		
				Checked		Kolbenstange / Piston Rod		
				Norm		KST $\varnothing 4$ M3,5x5; Nz 3,5x6,5 L=166		
						Description:		
						KST_-S-00263-E1		1
								A3
Rev.	Modification	Date	Name	Replaced by:	Replacement for:		MOD-Nr.: KST_-S-00263-EM	