

THE INFORMATION CONTAINED IN THIS DRAWING IS THE SOLE PROPERTY OF SUSPA INCORPORATED. ANY REPRODUCTION IN PART OR AS A WHOLE WITHOUT THE WRITTEN PERMISSION OF SUSPA INCORPORATED IS PROHIBITED.

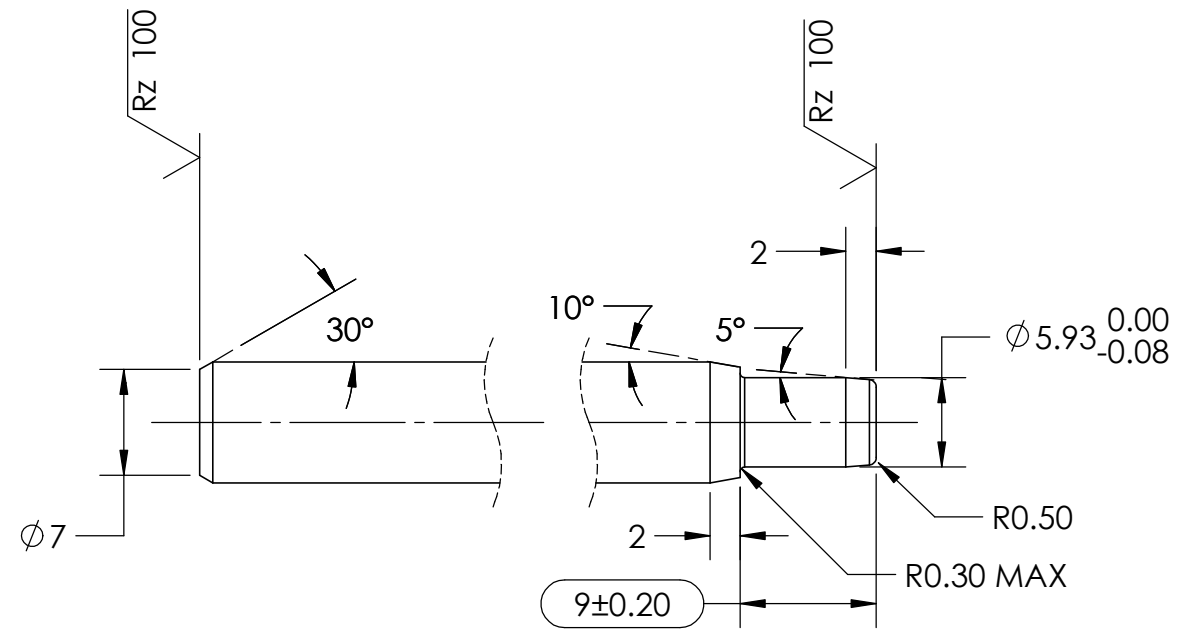

NOTES:

1. MUST BE CLEAN, FREE OF DEBRIS AND FREE OF BURRS.
2. NO IMPERFECTIONS ALLOWED IN AXIAL OR RADIAL DIRECTIONS.
3. \boxed{ST} = CRITICAL CHARACTERISTIC.
4. SALT BATH NITROCARBURIZED. CORROSION RESISTANCE TO BE >96HRS W/O RED RUST ACCORDING TO ASTM B117 IN "X" DIM AREA ONLY

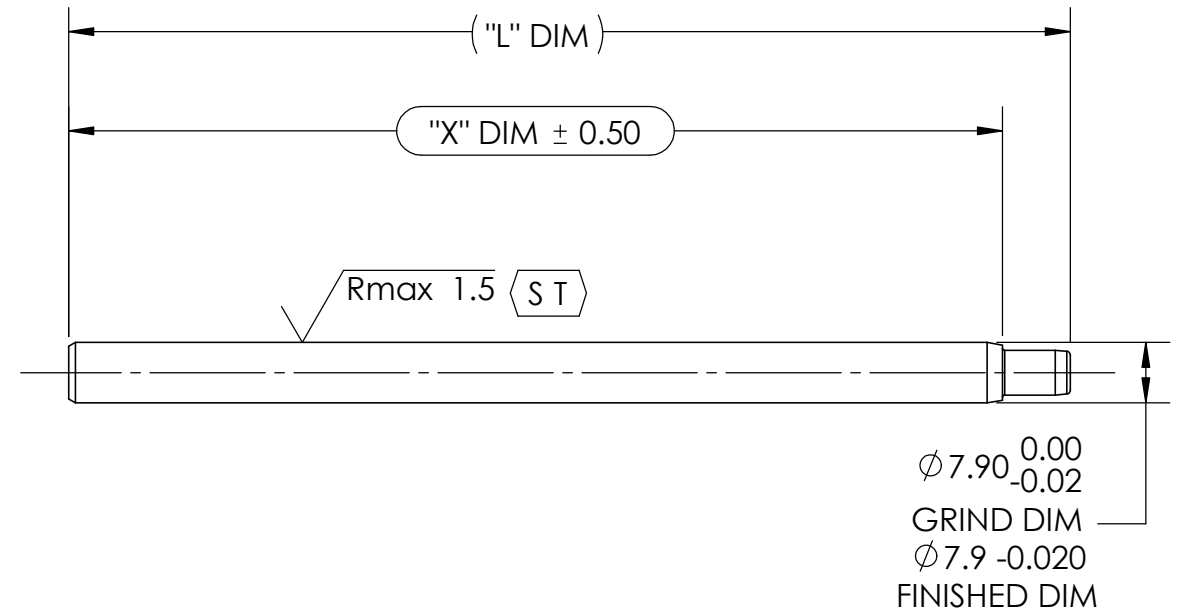

DO NOT MANUFACTURE TO THIS DRAWING UNLESS IT IS MARKED "CONTROLLED"

DO NOT SCALE THIS DRAWING DIMENSIONS ARE IN MILLIMETERS TOLERANCES UNLESS OTHERWISE SPECIFIED
 ONE PLACE DECIMAL +/-0.2 ANGULAR +/-2°
 TWO PLACE DECIMAL +/-0.1

DRAWN BY	DATE	SCALE	THIRD ANGLE PROJECTION
TSH	9/4/2019	1:1	

SHEET: 1 OF 2

REV	ECN	REVISIONS	CHANGED BY	APPROVED BY	DATE (MM/DD/YR)
DESCRIPTION					
8.0mm PISTON ROD, NO THREADS					
MATERIAL					
C45 (DIN EN 10250-2)					
DRAWING NUMBER					
G51-0008					
3970 Roger B. Chaffee S.E. Grand Rapids, Michigan 49548-3497 www.suspa-inc.com					DRAWING SIZE
					B

