

The print-out is not subject to the modification service.

Intended for internal and supplier use

EN

Ⓐ piston rod processing per STAB-Spec. 10028959, table 1

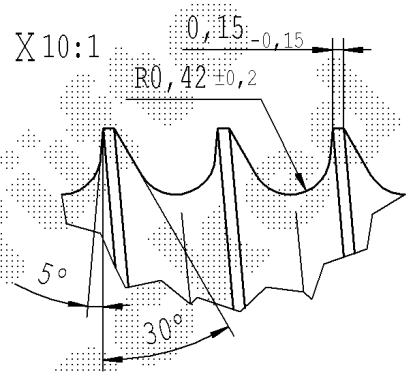
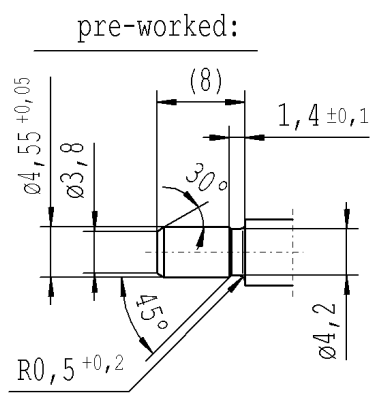
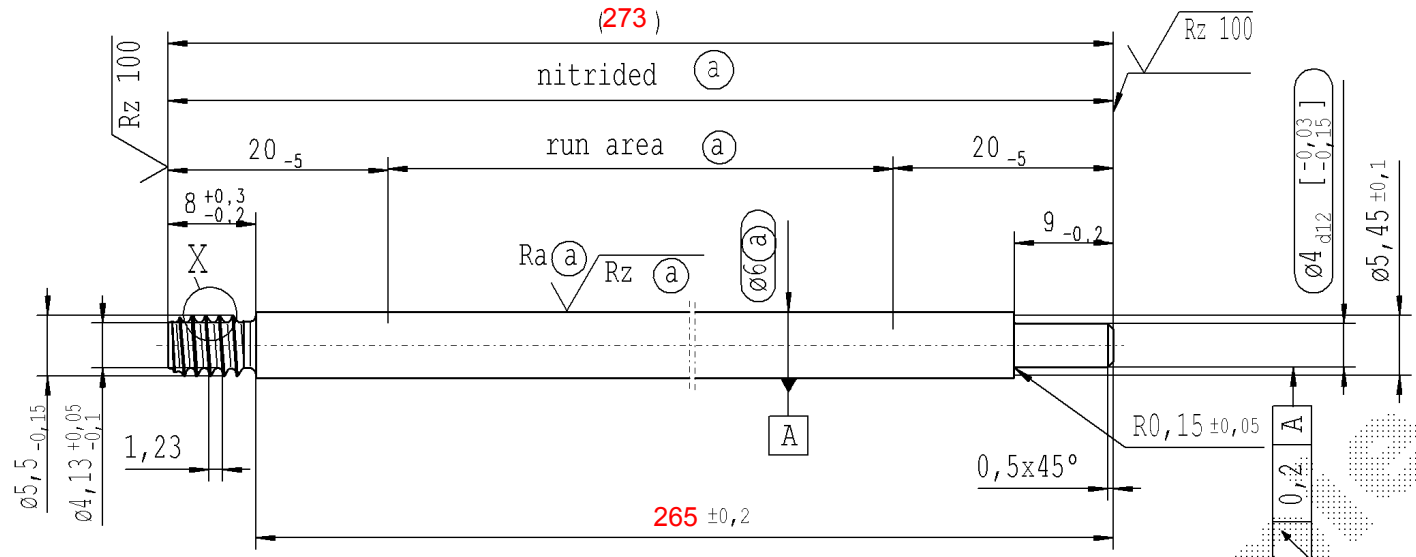

$\sqrt{Rz\ 25}$ ($\sqrt{Rz\ 100}$ $\overset{Ra(a)}{\sqrt{Ra(a)}}$ $\overset{Rz(a)}{\sqrt{Rz(a)}}$) $\overset{+0,2}{\sqrt{+0,2}}$ $\overset{-0,2}{\sqrt{-0,2}}$

AIAG CQI-standards acc. to STAB-Spec. 10027692

Environmental protection acc. to STAB-Spec. 10005649

DE: X	EN: X	ES:	IT:	PR:	FR:	RO:
new	INITIAL RELEASE					
old	-					
Field	-					
Date/Name	21.01.2020 Höfer					
Chg. No.	685394					
Rev.	0					

CAD created document; handwritten changes not permitted

Material: 1.1193
S45C JISG 4051

Edge tolerance acc. to DIN ISO 13715
Surface finish acc. to DIN EN ISO 1302

Replaces:

RELEASE
for supplier

company ZhangShi

Dat. 21.01.2020 Schilz A.
(date / signature)

STABILUS

All dimensions are in mm

Scale: (Original DIN A3) 2:1

Dimensions without tolerances DIN ISO 2768-mK

We reserve all rights to this document, to any patents or patent registrations related hereto, and to the duplication, retransmission by third parties and misc. use. Any use of this document is not permitted without the written consent of STABILUS.

Marking of special characteristics according to STAB-Spec. 10270932	Date	Name
Drawn by	21.01.2020	Höfer
Checked	21.01.2020	Milles
Document No.:	10177465	
Material No.:		

Ident. Doc.: L12