

The print-out is not subject to the modification service.

Intended for internal and supplier use

EN

8 7 6 5 4 3 2 1

ⓐ piston rod processing per STAB-Spec. 10028959, table 1

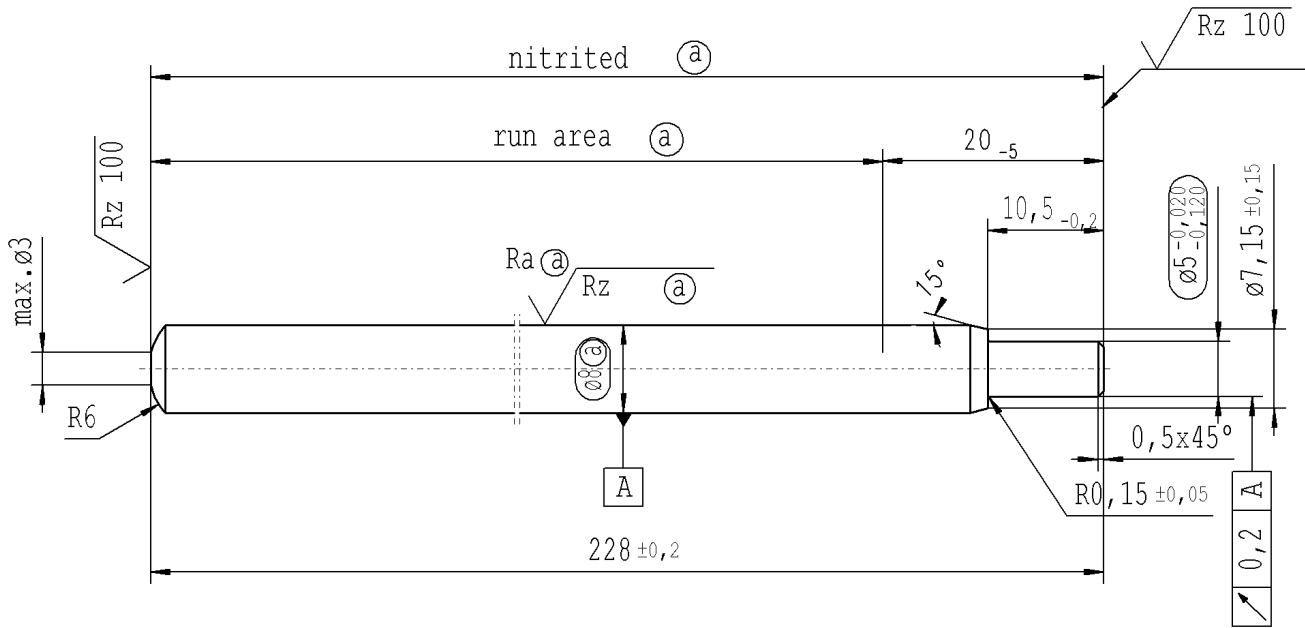

$\sqrt{Rz\ 25}$ ($\sqrt{Rz\ 100}$ $Ra\ \textcircled{a}$ $Rz\ \textcircled{a}$) $\begin{matrix} \swarrow +0,2 \\ \searrow -0,2 \end{matrix}$

AIAG CQI-standards acc. to STAB-Spec. 10027692 Environmental protection acc. to STAB-Spec. 10005649

Ident. Doc.: L11

DE: X	EN: X	ES:	IT:	PR:	FR:	RO:
new	INITIAL RELEASE					
old	-					
Field	-					
Date/Name	05.05.2020 Höfer					
Chg. No.	688234					
Rev.	0					

CAD created document; handwritten changes not permitted

RELEASE
for supplier

company **Zhang Shi**

Dat. 05.05.2020 Schilz A.
(date / signature)

Material:	1.1193 S45C JISG 4051
Edge tolerances acc. to DIN ISO 13715	
Surface finish	DIN ISO 1302
Replaces:	
STABILUS	

All dimensions are in mm	Marking of special characteristics according to STAB-Spec. 10270932	Drawn by	Date	Name
		Checked	05.05.2020	Höfer
Scale: (Original DIN A3) 2:1	Dimensions without tolerances DIN ISO 2768-mK	Document No.: 10242572		
We reserve all rights to this document, to any patents or patent registrations related hereto, and to the duplication, retransmission by third parties and misc. use. Any use of this document is not permitted without the written consent of STABILUS.		Material No.: 104010		

Environmental protection acc. to STAB-Spec. 10005649		
Drawn by	Date	Name
Checked	05.05.2020	Höfer
Document No.: 10242572		
Material No.: 104010		