

The print-out is not subject to the modification service.

Intended for internal and supplier use

EN

Ⓐ piston rod processing per STAB-Spec. 10028959, table 1

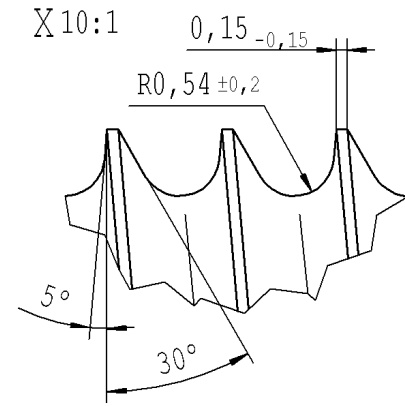
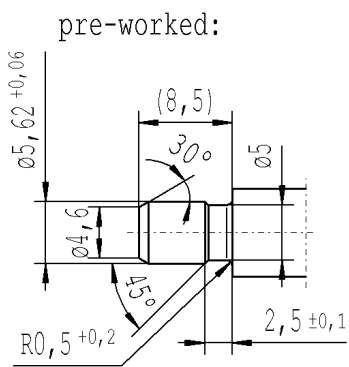
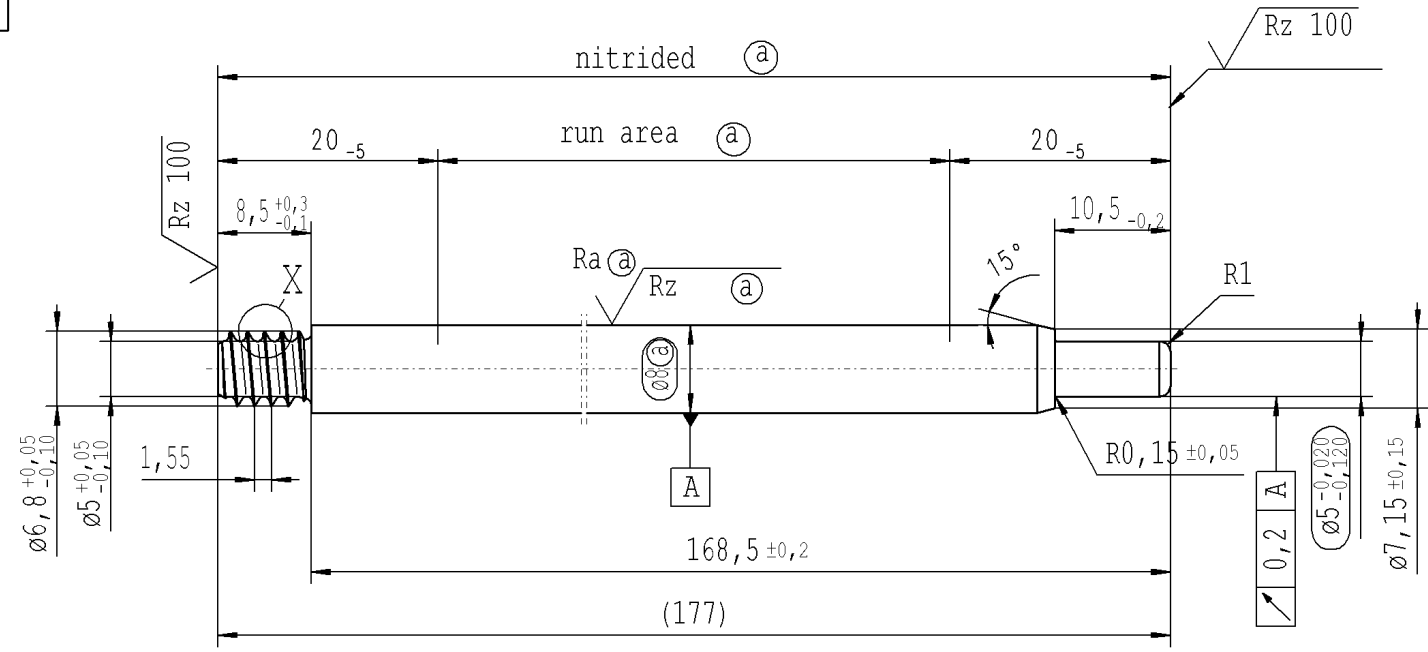

$\sqrt{Rz\ 25}$ ($\sqrt{Rz\ 100}$ $Ra\ \text{Ⓐ}$ $Rz\ \text{Ⓐ}$) $\begin{matrix} \swarrow +0,2 \\ \searrow -0,2 \end{matrix}$

AIAG CQI-standards acc. to STAB-Spec. 10027692

Environmental protection acc. to STAB-Spec. 10005649

Ident. Doc.: I20

DE: X	EN: X	ES:	IT:	PR:	FR:	RO:
new	INITIAL RELEASE					
old	-					
Field	-					
Date/Name	24.04.2020 Höfer					
Chg. No.	688121					
Rev.	0					

CAD created document; handwritten changes not permitted

RELEASE
for supplier

company **Zhang Shi**

Dat. 24.04.2020 Schilz A.
(date / signature)

Material:	1.1193 S45C JISG 4051
Edge tolerances acc. to DIN ISO 13715	
Surface finish	DIN EN ISO 1302
Replaces:	
STABILUS	

All dimensions are in mm	Marking of special characteristics according to STAB-Spec. 10270932	Date	Name
		24.04.2020	Höfer
Scale:	Dimensions without tolerances	Checked	Keck
(Original DIN A3) 2:1	DIN ISO 2768-mK		
We reserve all rights to this document, to any patents or patent registrations related hereto, and to the duplication, retransmission by third parties and misc. use. Any use of this document is not permitted without the written consent of STABILUS.		Document No.:	10243257
		Material No.:	043543