

The print-out is not subject to the modification service.

Intended for internal and supplier use

Ident. Doc.: EFFE11.docx: 17/3/2020 - 14:13

supp No.	material no.			A	E
	processing and surface treatment acc. to STAB-Spec.				
	10006248 Tab. IV version 1	10006248 Tab. X version 1	10028959 Tab. I version 2	overall length	length without endfitting stud
1		008586	008586	220.5	211.0
2		005515	005515	267.0	257.5
3		005523	005523	166.0	156.5
4		005526	005526	252.0	242.5
5	005530	005530	005530	173.5	164.0
6		005545	005545	243.0	233.5
7		005556	005556	201.5	192.0
8		005563	005563	148.0	138.5
9		005572	005572	183.0	173.5
10		005628	005628	144.0	134.5
11		005634	005634	171.0	161.5
12		005639	005639	144.5	135.0
13		005644	005644	266.5	257.0
14		005653	005653	210.0	200.5
15		005662	005662	259.0	249.5
16		005702	005702	178.0	168.5
17		005752	005752	273.0	263.5
18		005760	005760	235.0	225.5
19		005779	005779	255.0	245.5

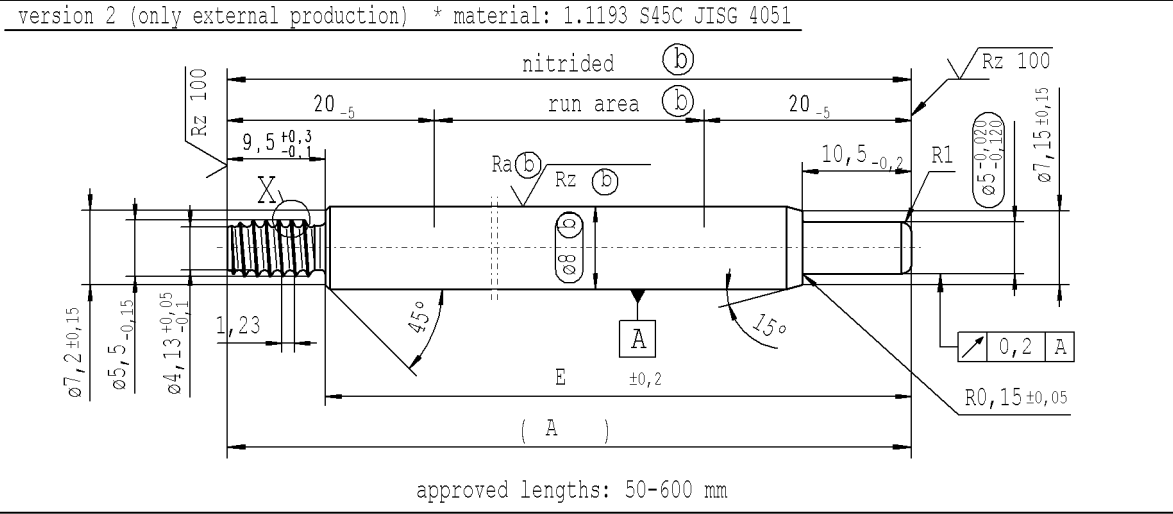
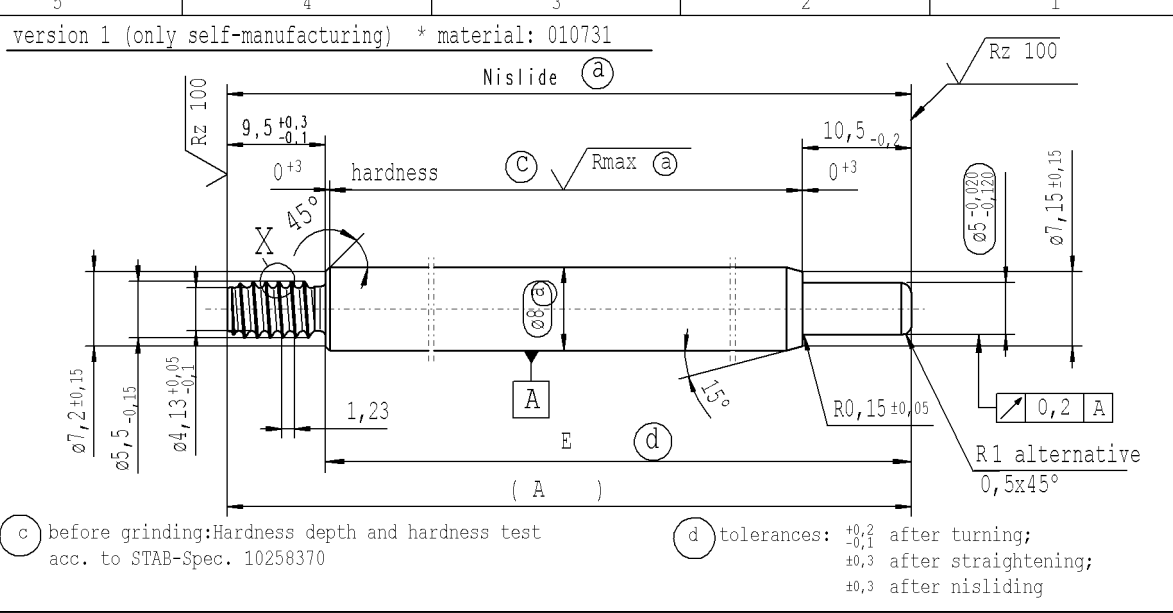

pre-worked: (only self-manufacturing)

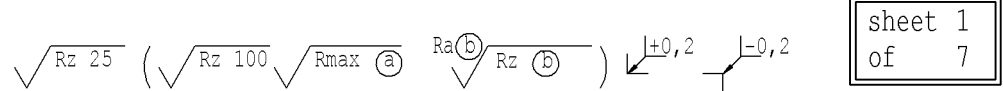
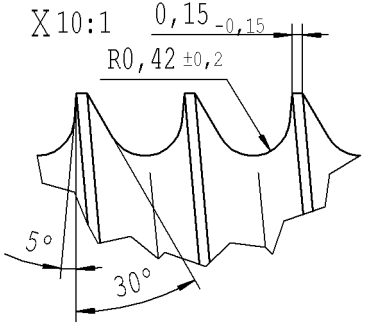
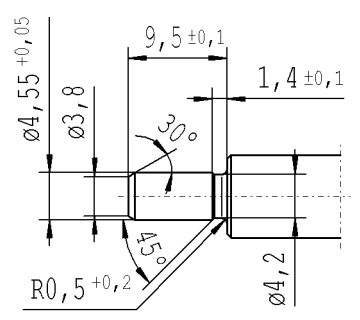

sheet 1 of 7

DE: X				EN: X				ES: X				IT: X				PR: X				FR: X				RO: X				Material: *				All dimensions are in mm				Marking of special characteristics according to STAB-Spec. 10270932				Date: 05.12.2007				Name: Höfer			
new				ZhangShi				detail X reworked				© = acc. STAB-Spec. 10258370				new format Internal/Supplier				CRD created document; handwritten changes not permitted				Surface finish: DIN EN ISO 1302				Scale: (Original DIN A3) 2:1				Dimensions without tolerances: DIN ISO 2768-mK				Checked: 17.03.2020				Klinkner							
old				China				-				© = RHT 0,4 ... 0,7 mm				Supplier drawing separately				Edge tolerances acc. to DIN ISO 13715				We reserve all rights to this document, to any patents or patent registrations related hereto, and to the duplication, retransmission by third parties and misc. use. Any use of this document is not permitted without the written consent of STABILUS.				Document No.: 10151066																			
Field				C2/F7				E-F/4-5				B 4-5				-				Replaces:				Material No.:																							
Date/Name				20.04.2017 Höfer				03.05.2019 Hein				15.05.2019 Jablonski				17.03.2020 Höfer																															
Chg. No.				655549				677347				678682				687147																															
Rev.				11				12				13				14																															

**STABILUS**

PISTON ROD

The print-out is not subject to the modification service.

Intended for internal and supplier use

Ident. Doc.: EFFE11.docx: 17/3/2020 - 14:13

supp No.	material no.			A	E
	processing and surface treatment acc. to STAB-Spec.				
	10006248 Tab. IV version 1	10006248 Tab. X version 1	10028959 Tab. I version 2		
21		005830	005830	283.0	273.5
22		005833	005833	113.0	103.5
24		006562	006562	256.5	247.0
25		006568	006568	207.0	197.5
26		1581VJ	1581VJ	270.0	260.5
28		1632VA	1632VA	148.0	138.5
29		1622VG	1622VG	294.0	284.5
30		8489YQ	8489YQ	163.5	154.0
31		8533YP	8533YP	158.0	148.5
32		016537	016537	118.5	109.0
33		022626	022626	273.5	264.0
34		023309	023309	278	268.5
35		027502	027502	203.5	194.0
36		026394	026394	297.0	287.5
37		032580	032580	260.5	251.0
38		054876	054876	231.0	221.5
39		035222	035222	216.0	206.5
40		957707	957707	264.0	254.5
41		152006	152006	161.0	151.5

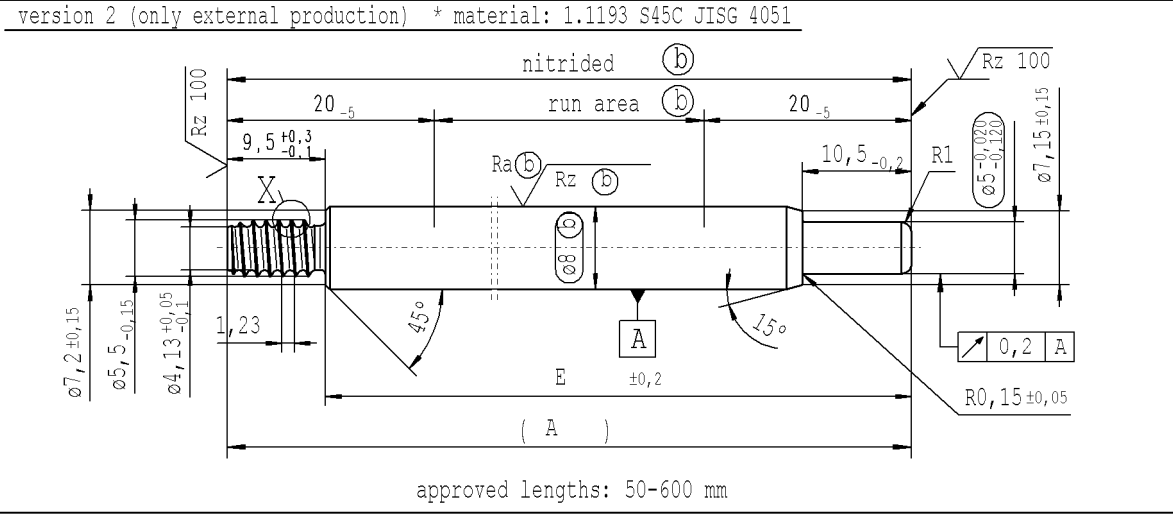
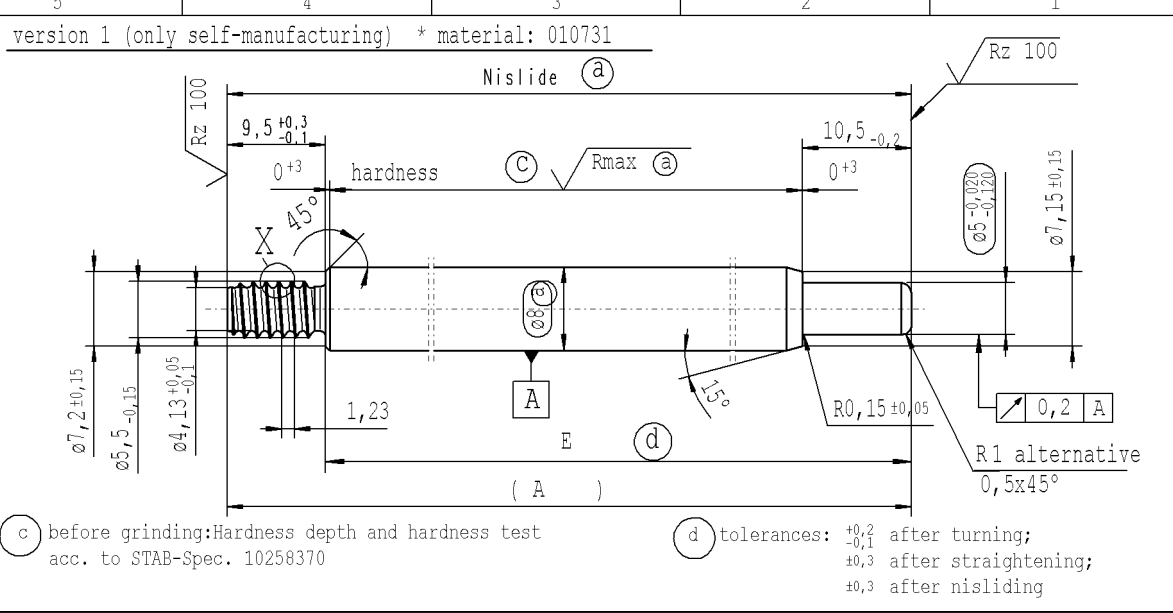

pre-worked: (only self-manufacturing)

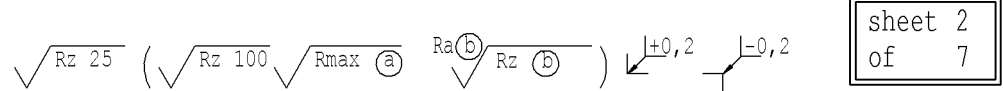
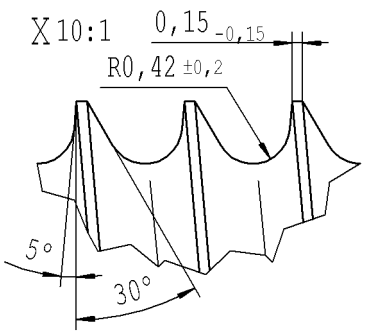
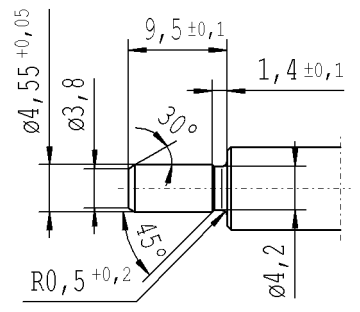

sheet 2 of 7

DE: X				EN: X				ES: X				IT: X				PR: X				FR: X				RO: X				Material: *				All dimensions are in mm				Marking of special characteristics according to STAB-Spec. 10270932				Date: 05.12.2007				Name: Höfer			
new				ZhangShi				detail X reworked				⊙ = acc. STAB-Spec. 10258370				new format Internal/Supplier				CRD created document; handwritten changes not permitted				Surface finish: DIN EN ISO 1302				Scale: (Original DIN A3) 2:1				Dimensions without tolerances: DIN ISO 2768-mK				Checked: 17.03.2020				Klinkner							
old				China				-				⊙ = RHT 0,4 ... 0,7 mm				Supplier drawing separately				Edge tolerances acc. to DIN ISO 13715				We reserve all rights to this document, to any patents or patent registrations related hereto, and to the duplication, retransmission by third parties and misc. use. Any use of this document is not permitted without the written consent of STABILUS.				Document No.: 10151066																			
Field				C2/F7				E-F/4-5				B 4-5				-				Replaces:				Material No.:																							
Date/Name				20.04.2017 Höfer				03.05.2019 Hein				15.05.2019 Jablonski				17.03.2020 Höfer																															
Chg. No.				655549				677347				678682				687147																															
Rev.				11				12				13				14																															

**STABILUS**

PISTON ROD

The print-out is not subject to the modification service.

Intended for internal and supplier use

Ident. Doc.: EFFE11.dwg: 17/3/2020 - 14:13

supp No.	material no.			A	E
	processing and surface treatment acc. to STAB-Spec.				
	10006248 Tab. IV (a) version 1	10006248 Tab. X (a) version 1	10028959 Tab. I (b) version 2		
42		208888	208888	354.0	344.5
43	439286		439286	229.0	219.5
44	440003		440003	240.0	230.5
45	440242		440242	217.0	207.5
46	440481		440481	226.0	216.5
47	441437		441437	211.0	201.5
48	441915		441915	150.0	140.5
49	442632		442632	215.0	205.5
50		681394	681394	191.0	181.5
51	134085		134085	155	145.5
52		764088	764088	304.0	294.5
53		764327	764327	257.0	247.5
54		969150	969150	159.0	149.5
55		377387	377387	236.0	226.5
56		455301	455301	156.0	146.5
57		456496	456496	129.0	119.5
58		460320	460320	226.0	216.5
59		463427	463427	150.0	140.5
60		468685	468685	261.0	251.5

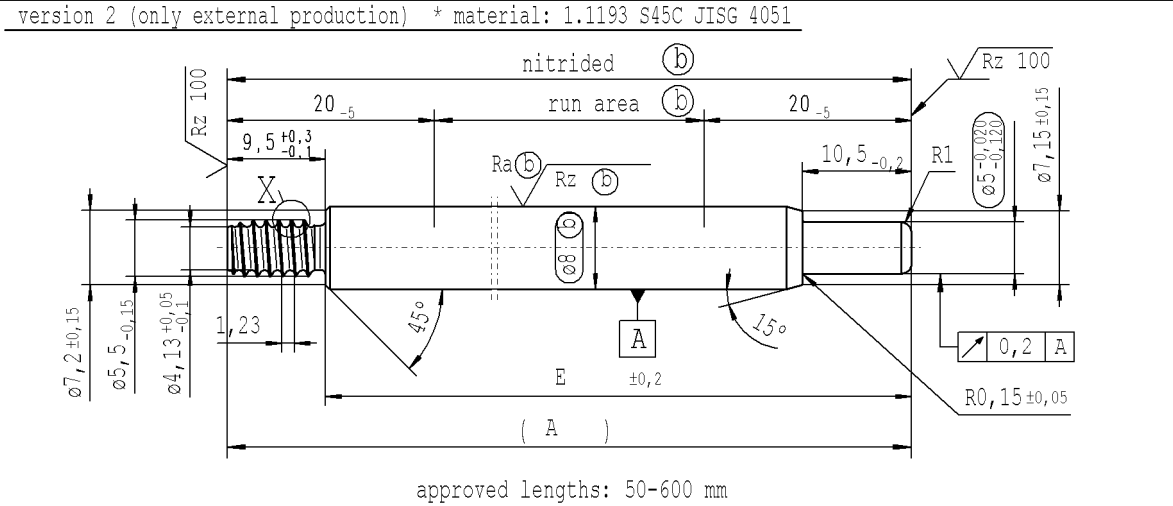
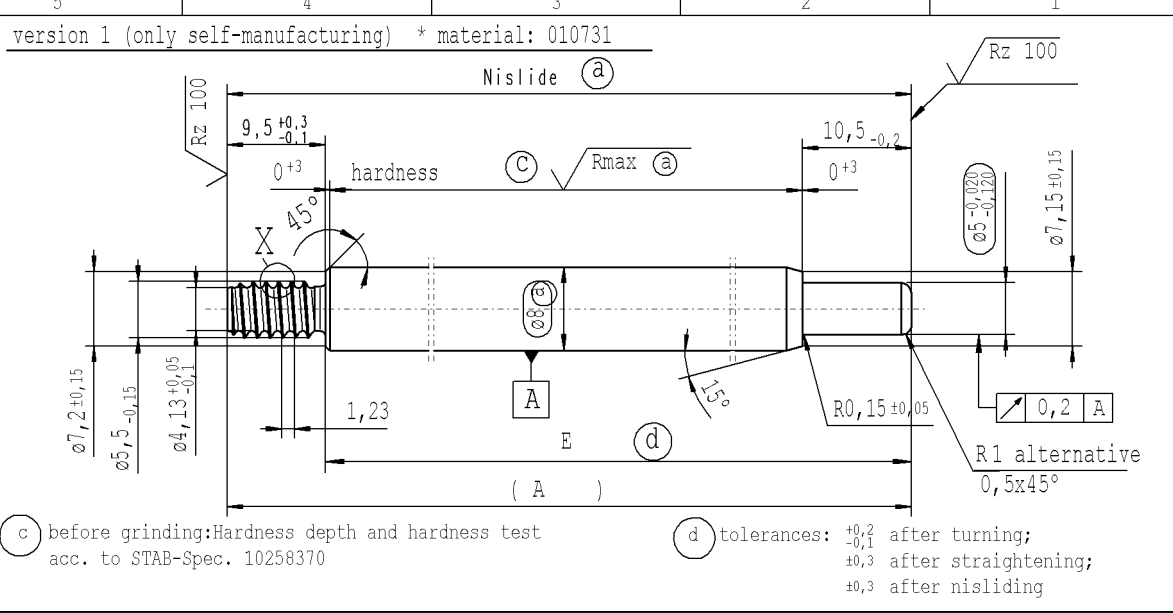

pre-worked: (only self-manufacturing)

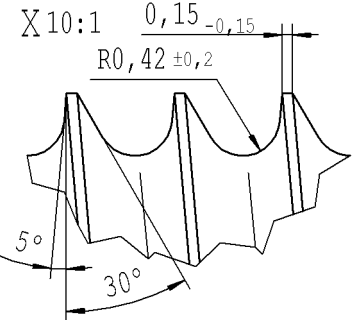
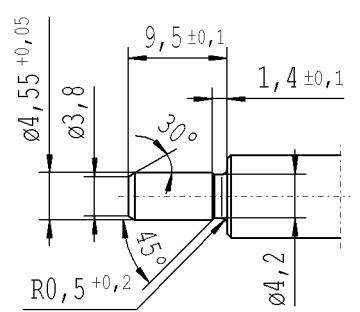

sheet 3 of 7

DE: X				EN: X		ES:		IT:		PR: X		FR:		RO: X		Material: *		All dimensions are in mm		Marking of special characteristics according to STAB-Spec. 10270932		Date		Name	
new				ZhangShi		detail X reworked		⊙ = acc. STAB-Spec. 10258370		new format Internal/Supplier						Edge tolerances acc. to DIN ISO 13715		Scale: (Original DIN A3) 2:1		Dimensions without tolerances DIN ISO 2768-mK		Drawn by		Höfer	
old				China		-		⊙ = RHT 0,4 ... 0,7 mm		Supplier drawing separately						Surface finish DIN EN ISO 1302						Checked		Klinkner	
Field				C2/F7		E-F/4-5		B 4-5		-												Document No.:		10151066	
Date/Name				20.04.2017 Höfer		03.05.2019 Hein		15.05.2019 Jablonski		17.03.2020 Höfer												Material No.:			
Chg. No.				655549		677347		678682		687147															
Rev.				11		12		13		14															
AIAG CQI-standards acc. to STAB-Spec. 10027692																Environmental protection acc. to STAB-Spec. 10005649									
CRD created document; handwritten changes not permitted																We reserve all rights to this document, to any patents or patent registrations related hereto, and to the duplication, retransmission by third parties and misc. use. Any use of this document is not permitted without the written consent of STABILUS.									
<b>STABILUS</b>																<b>PISTON ROD</b>									

The print-out is not subject to the modification service.

Intended for internal and supplier use

Ident. Doc.: EFFE11.dwg: 17/3/2020 - 14:13

supp No.	material no.			A	E
	processing and surface treatment acc. to STAB-Spec.				
	10006248 Tab. IV version 1	10006248 Tab. X version 1	10028959 Tab. I version 2		
61		471075	471075	232.0	222.5
62		471553	471553	274.0	264.5
63		966283	966283	153.0	143.5
64	456976	456976	456976	372.0	362.5
65		496172	496172	223.0	213.5
66		460323	460323	306.0	296.5
67	183084		183084	198.0	188.5
68	328874	328874	328874	327.0	317.5
69	539433	539433	539433	339.0	329.5
70		297088	297088	201.0	191.5
71	333655	333655	333655	132.5	123.0
72		333894	333894	246.0	236.5
73	364009	364009	364009	291.0	281.5
74	754298		754298	219.0	209.5
75	960316		960316	261.0	251.5
76	626434	626434	626434	276.0	266.5
77	859698	859698	859698	340.5	331.0
78	484232	484232	484232	258.0	248.5
79	500962	500962	500962	234.0	224.5

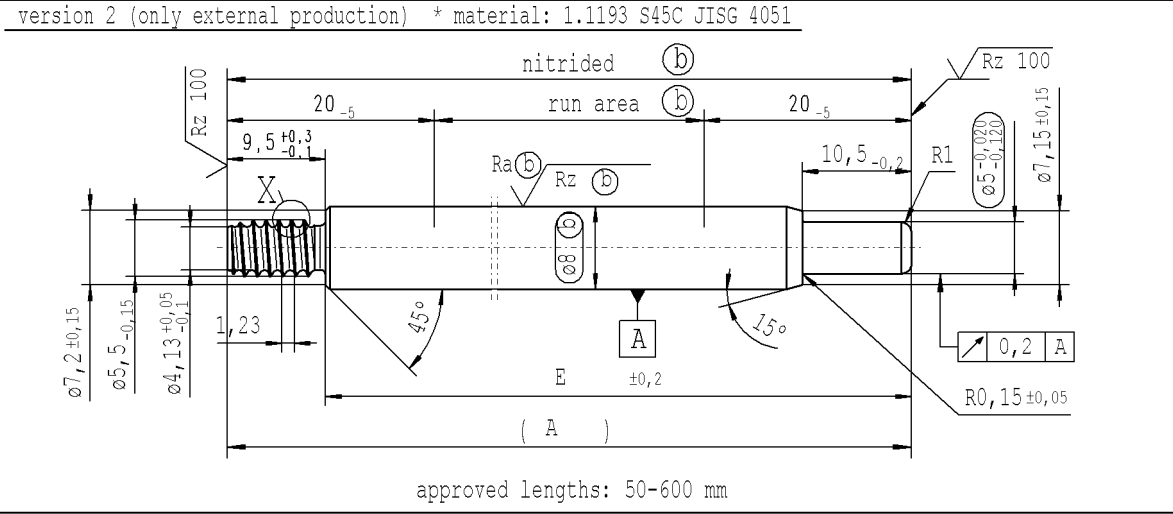
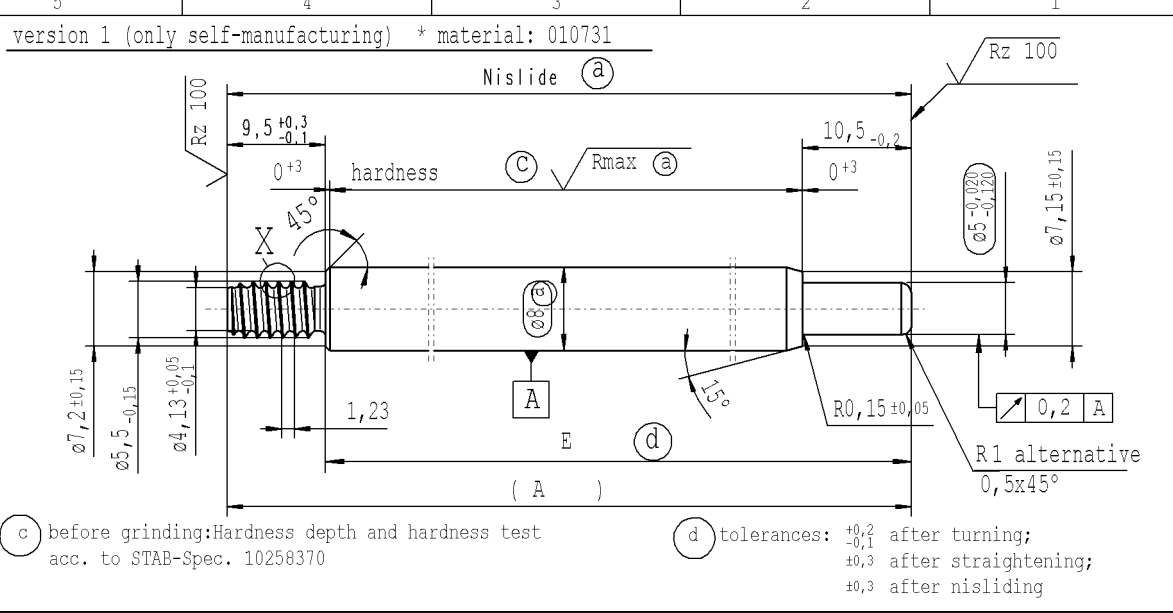

pre-worked: (only self-manufacturing)

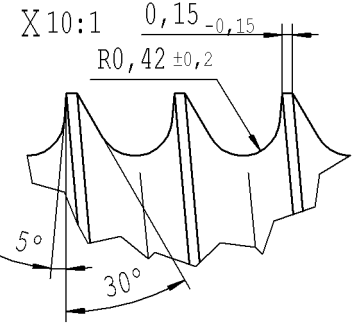
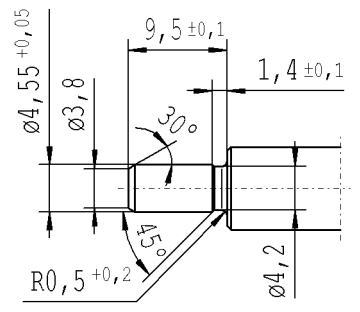

DE: X				EN: X		ES:		IT:		PR: X		FR:		RO: X		Material: *		All dimensions are in mm		Marking of special characteristics according to STAB-Spec. 10270932		Date		Name			
new				ZhangShi		detail X reworked		⊙ = acc. STAB-Spec. 10258370		new format Internal/Supplier						Edge tolerances acc. to DIN ISO 13715		Scale: (Original DIN A3) 2:1		Dimensions without tolerances DIN ISO 2768-mK		Drawn by		Höfer			
old				China		-		⊙ = RHT 0,4 ... 0,7 mm		Supplier drawing separately						Surface finish DIN EN ISO 1302						Checked		17.03.2020		Klinkner	
Field				C2/F7		E-F/4-5		B 4-5		-						Replaces:						Document No.:		10151066			
Date/Name				20.04.2017 Höfer		03.05.2019 Hein		15.05.2019 Jablonski		17.03.2020 Höfer												Material No.:					
Chg. No.				655549		677347		678682		687147																	
Rev.				11		12		13		14																	

**STABILUS**

PISTON ROD

sheet 4 of 7

The print-out is not subject to the modification service.

Intended for internal and supplier use

Ident. Doc.: ERP011.dwg; 17/03/2020 - 14:13

supp No.	material no.			A	E
	processing and surface treatment acc. to STAB-Spec.				
	10006248 Tab. IV (a) version 1	10006248 Tab. X (a) version 1	10028959 Tab. I (b) version 2		
80	201257	201257	201257	192.0	182.5
81	135533	135533	135533	168.0	158.5
82	611382	611382	611382	177.0	167.5
83	077935	077935	077935	159.5	150.0
84	088451	088451	088451	165.5	156.0
85	147486	147486	147486	114.0	104.5
86	440263	440263	440263	102.0	92.5
87	440502	440502	440502	300.0	290.5
88	440741	440741	440741	402.0	392.5
89	450779	450779	450779	501.0	491.5
90	451018	451018	451018	600.0	590.5
91	265076	265076	265076	249.0	239.5
92	345619	345619	345619	429.0	419.5
93	382425	382425	382425	141.0	131.5
94	104708	104708	104708	188.0	178.5
95	105903	105903	105903	204.0	194.5
96	108771	108771	108771	273.0	263.5
97	114268	114268	114268	157.0	147.5
98	117136	117136	117136	135.5	126.0

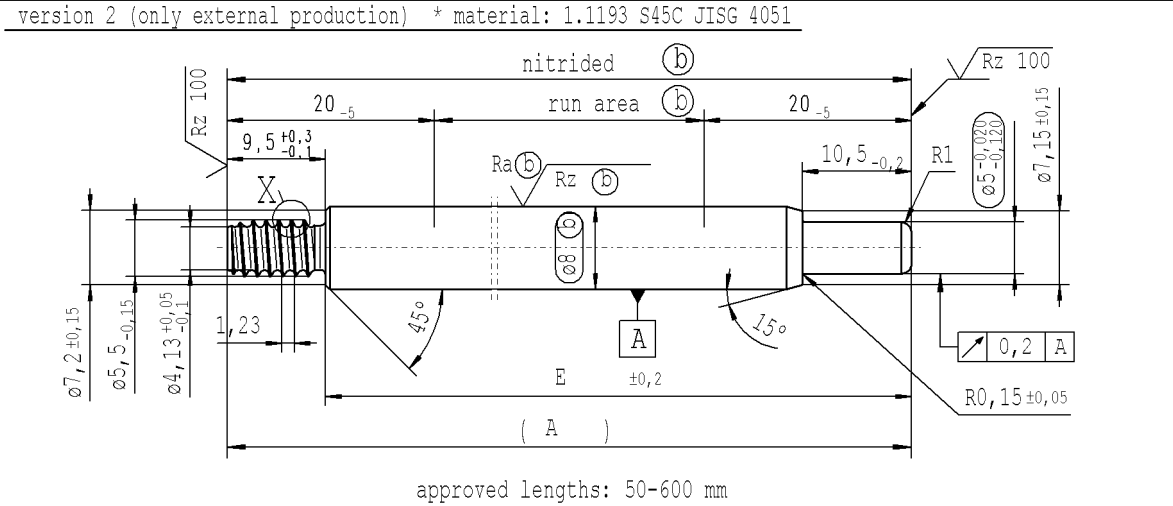
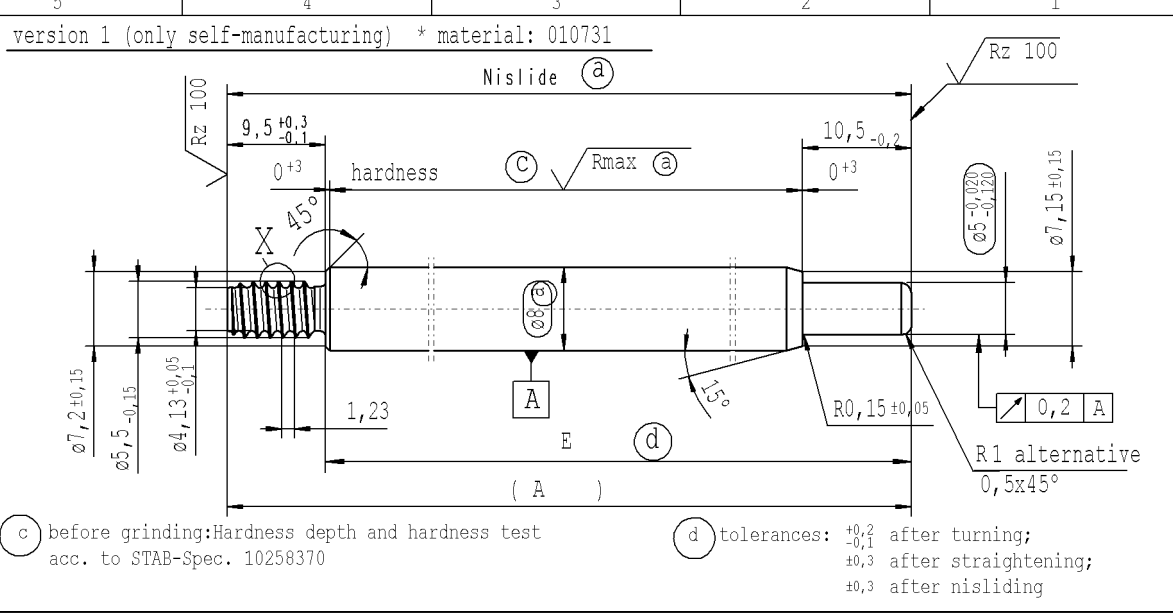

pre-worked: (only self-manufacturing)

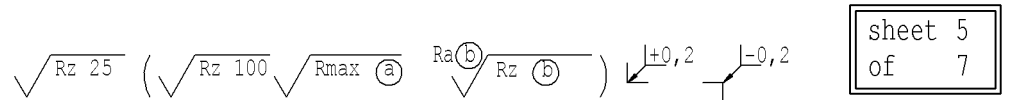
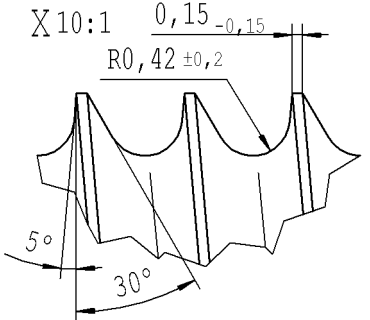
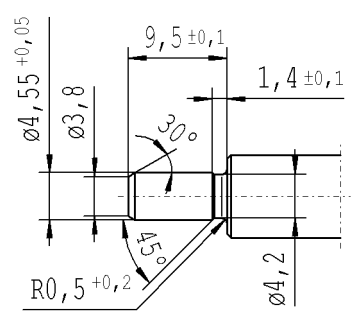

sheet 5 of 7

DE: X				EN: X				ES: X				IT: X				PR: X				FR: X				RO: X				Material: *				All dimensions are in mm				Marking of special characteristics according to STAB-Spec. 10270932				Date: 05.12.2007				Name: Höfer			
new				ZhangShi				detail X reworked				© = acc. STAB-Spec. 10258370				new format Internal/Supplier				CRD created document; handwritten changes not permitted				Surface finish: DIN EN ISO 1302				Scale: (Original DIN A3) 2:1				Dimensions without tolerances: DIN ISO 2768-mK				Checked: 17.03.2020				Klinkner							
old				China				-				© = RHT 0,4 ... 0,7 mm				Supplier drawing separately				Edge tolerances acc. to DIN ISO 13715				We reserve all rights to this document, to any patents or patent registrations related hereto, and to the duplication, retransmission by third parties and misc. use. Any use of this document is not permitted without the written consent of STABILUS.				Document No.: 10151066																			
Field				C2/F7				E-F/4-5				B 4-5				-				Replaces:								Material No.:																			
Date/Name				20.04.2017 Höfer				03.05.2019 Hein				15.05.2019 Jablonski				17.03.2020 Höfer																															
Chg. No.				655549				677347				678682				687147																															
Rev.				11				12				13				14																															

**STABILUS**

PISTON ROD

The print-out is not subject to the modification service.

Intended for internal and supplier use

Ident. Doc.: ERF011.dwg; 17/3/2020 - 14:13

supp No.	material no.			A	E
	processing and surface treatment acc. to STAB-Spec.				
	10006248 Tab. IV (a) version 1	10006248 Tab. X (a) version 1	10028959 Tab. I (b) version 2		
99	117614	117614	117614	156.5	147.0
100	124067	124067	124067	149.5	140.0
101	127413	127413	127413	208.0	198.5
102	130998	130998	130998	153.5	144.0
103	198157	198157	198157	189.0	179.5
104	267706	267706	267706	99.0	89.5
105	516506	516506	516506	111.0	101.5
106	526544	526544	526544	195.0	185.5
107	868073	868073	868073	213.0	203.5
108	206527	206527	206527	157.5	148.0
109	207961	207961	207961	267.5	258.0
110	348015	348015	348015	252.0	242.5
111	350644	350644	350644	241.0	231.5
112	368330	368330	368330	239.0	229.5
113		383865	383865	200.5	191.0
114	626689	626689	626689	278.5	269.0
115	292568	292568	292568	132.0	122.5
116	644615	644615	644615	84.0	74.5
117	712017	712017	712017	375.0	365.5

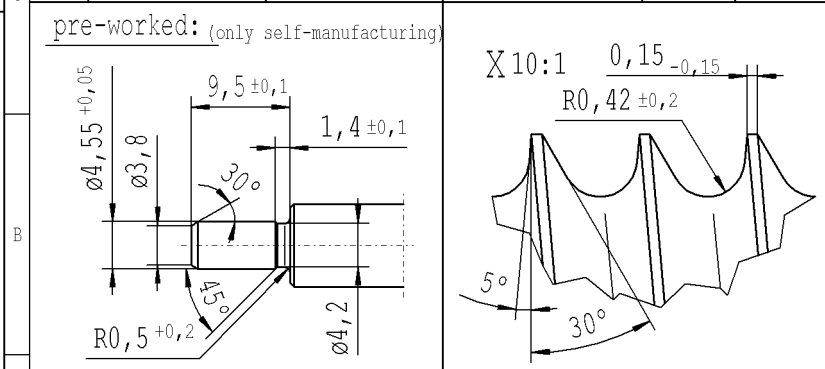
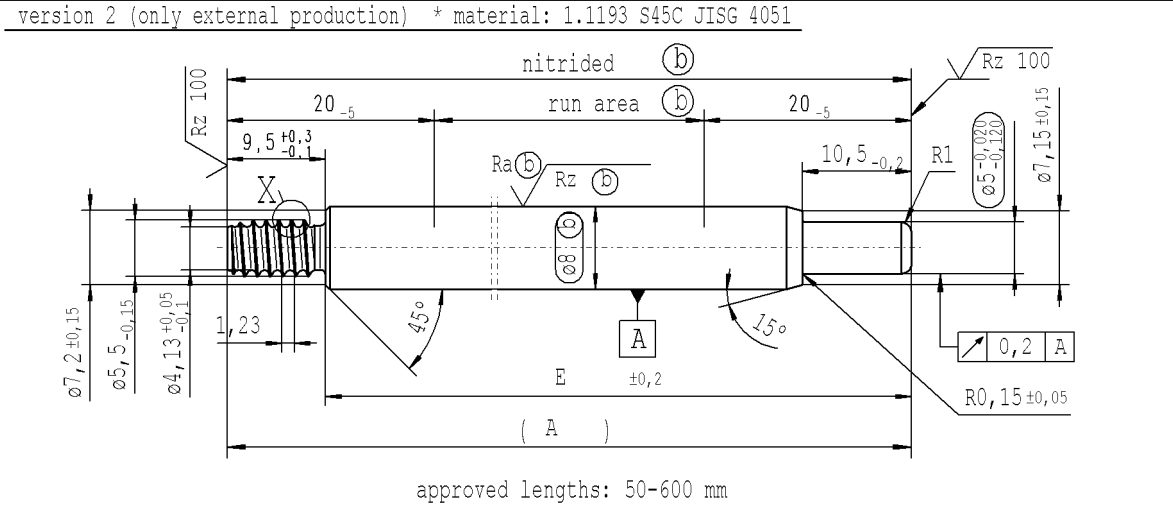
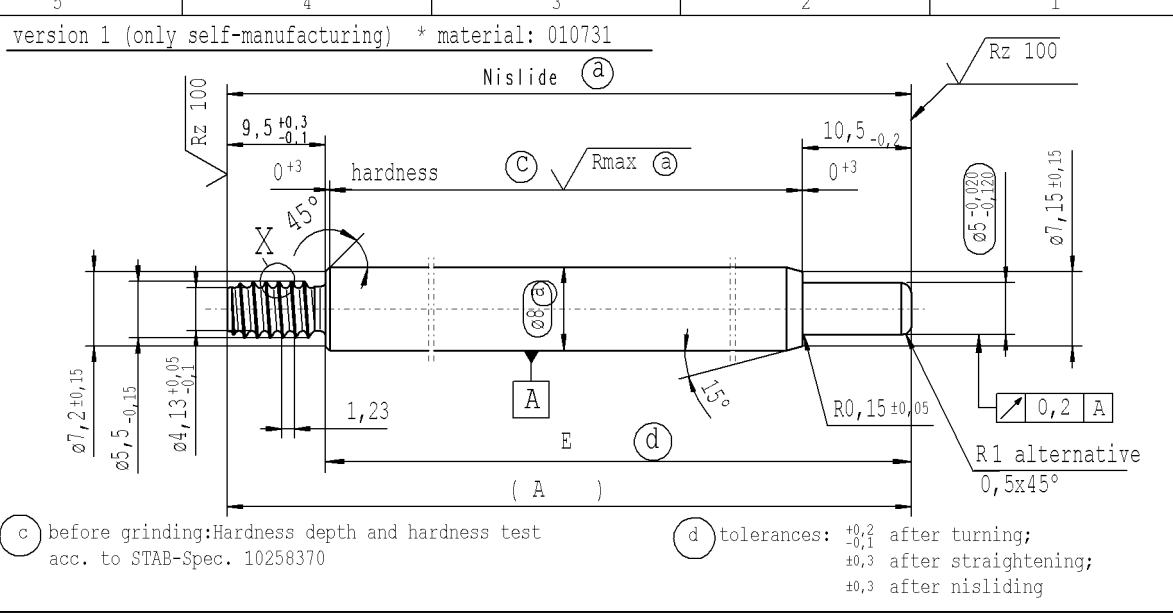

DE: X				EN: X				ES: X				IT: X				PR: X				FR: X				RO: X				Material: *				All dimensions are in mm				Marking of special characteristics according to STAB-Spec. 10270932				Date: 05.12.2007				Name: Höfer			
new				ZhangShi				detail X reworked				© = acc. STAB-Spec. 10258370				new format Internal/Supplier				Surface finish: DIN EN ISO 1302				Scale: (Original DIN A3) 2:1				Dimensions without tolerances: DIN ISO 2768-mK				Checked: 17.03.2020				Klinkner											
old				China				-				© = RHT 0,4 ... 0,7 mm				Supplier drawing separately				Edge tolerances acc. to DIN ISO 13715				We reserve all rights to this document, to any patents or patent registrations related hereto, and to the duplication, retransmission by third parties and misc. use. Any use of this document is not permitted without the written consent of STABILUS.				Document No.: 10151066																			
Field				C2/F7				E-F/4-5				B 4-5				-				Replaces:				Material No.:																							
Date/Name				20.04.2017 Höfer				03.05.2019 Hein				15.05.2019 Jablonski				17.03.2020 Höfer																															
Chg. No.				655549				677347				678682				687147																															
Rev.				11				12				13				14																															

sheet 6 of 7

**STABILUS**

PISTON ROD

The print-out is not subject to the modification service.

Intended for internal and supplier use

Ident. Doc.: EFFE11.dwg: 17/3/2020 - 14:13

supp No.	material no.			A	E
	processing and surface treatment acc. to STAB-Spec.				
	10006248 Tab. IV version 1	10006248 Tab. X version 1	10028959 Tab. I version 2		
118	655136	655136	655136	117.0	107.5
119	722295	722295	722295	120.0	110.5
120	872148	872148	872148	321.0	311.5
121	554996	554996	554996	222.0	212.5
122	570053	570053	570053	219.0	209.5
123	313607	313607	313607	299.5	290.0
124	862590	862590	862590	237.0	227.5
125	428089	428089	428089	282.0	272.5
126	430001	430001	430001	228.0	218.5
127	125995	125995	125995	180.0	170.5
128	718477	718477	718477	279.0	269.5

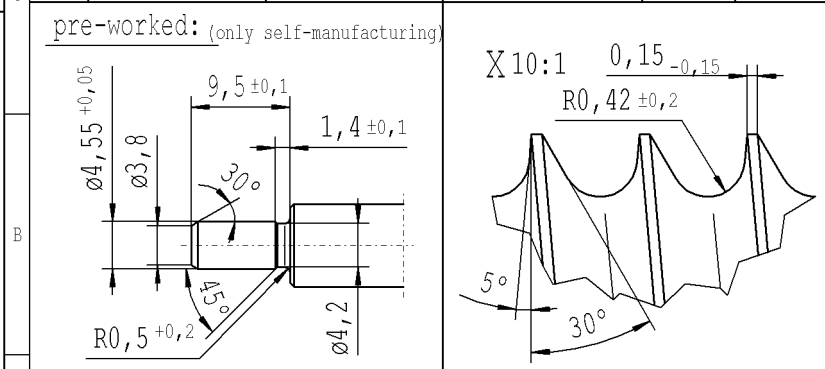
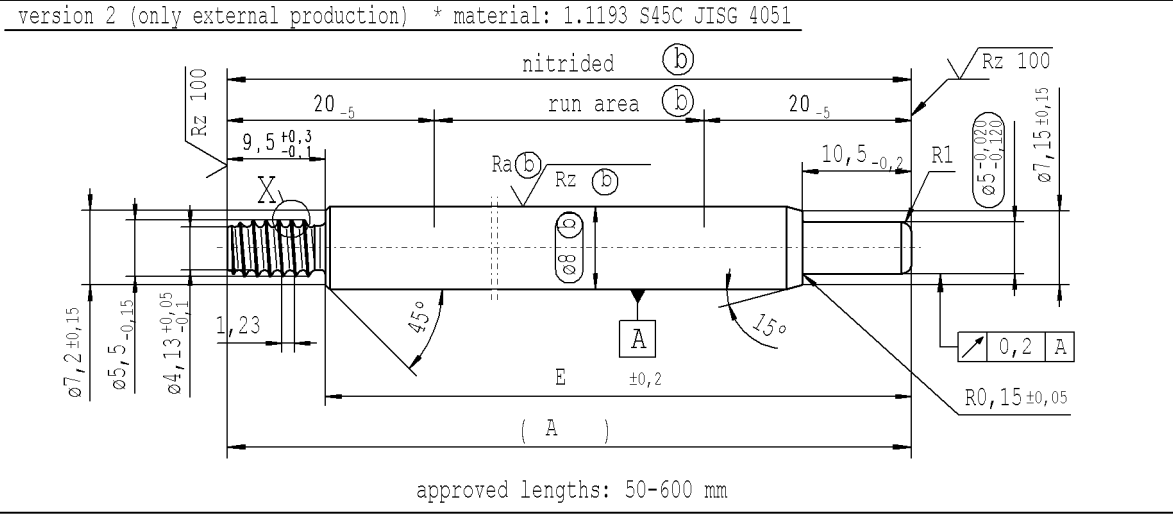
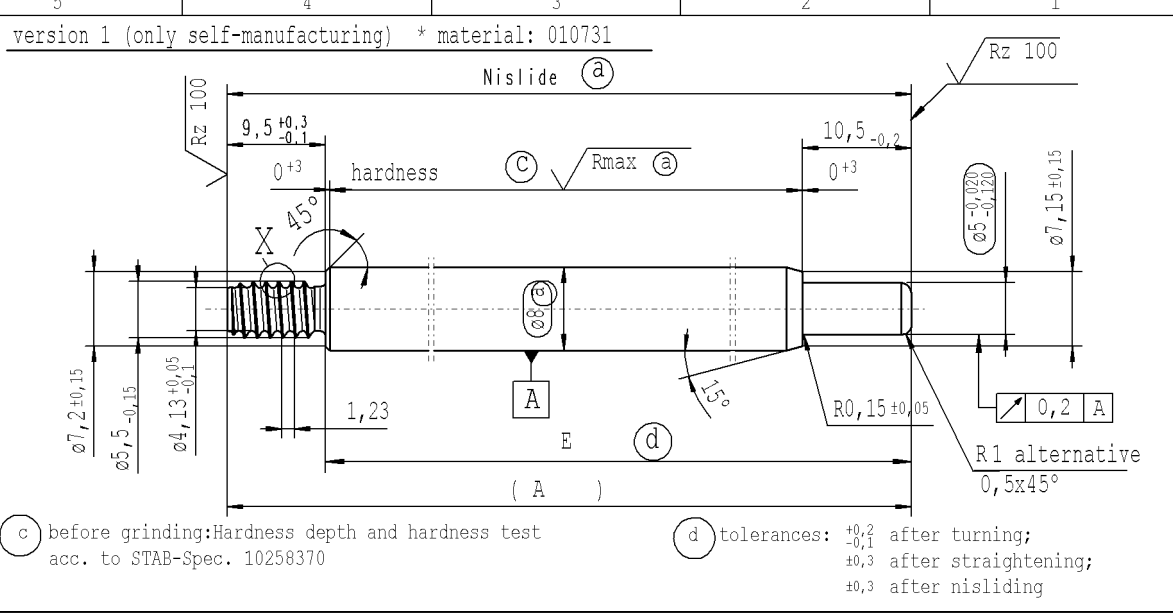

DE: X				EN: X				ES: X				IT: X				PR: X				FR: X				RO: X				Material: *				All dimensions are in mm				Marking of special characteristics according to STAB-Spec. 10270932				Date: 05.12.2007				Name: Höfer			
new				ZhangShi				detail X reworked				© = acc. STAB-Spec. 10258370				new format Internal/Supplier				Surface finish acc. to DIN ISO 13715				Scale: (Original DIN A3) 2:1				Dimensions without tolerances DIN ISO 2768-mK				Checked by: 17.03.2020				Klinkner											
old				China				-				© = RHT 0,4 ... 0,7 mm				Supplier drawing separately				Surface finish DIN EN ISO 1302				We reserve all rights to this document, to any patents or patent registrations related hereto, and to the duplication, retransmission by third parties and misc. use. Any use of this document is not permitted without the written consent of STABILUS.				Document No.: 10151066				Material No.:															
Field				C2/F7				E-F/4-5				B 4-5				-				Replaces:				STABILUS				PISTON ROD				Material No.:															
Date/Name				20.04.2017 Höfer				03.05.2019 Hein				15.05.2019 Jablonski				17.03.2020 Höfer																															
Chg. No.				655549				677347				678682				687147																															
Rev.				11				12				13				14																															

sheet 7 of 7