

DATA	REW	ZM	OPIS ZMIANY	NR ZMIANY	WYK	ZATW
21.09.2020	01		tylko dla oferty			TK

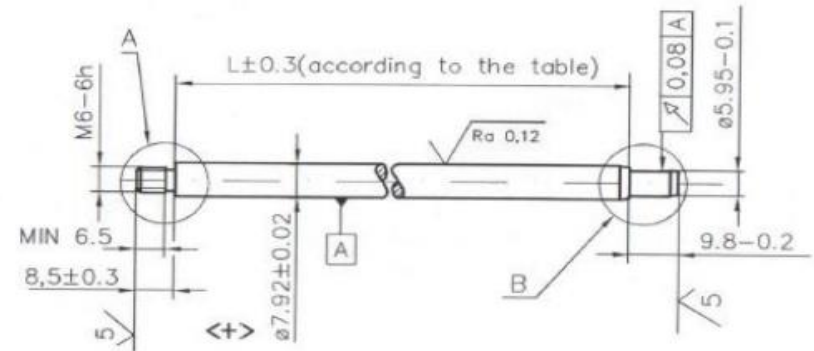

REMARKS:

- <+> 1. IN LENGTH L IS UNACCEPTABLE DEFECTS FACES OF
- STRAIGHTNESS MAX. 0,1mm ALL ALONG FOR $L < 120$ mm, AND MAX 0,1 IN LENGTH 100mm FOR $L \geq 120$ mm.
 - PISTON ROD:
 - nitrated a. oxidized
 - Compound layer: to supplier standard
 - Layer hardness: to supplier standard
 - Corrosion resistance 120h acc. ISO 9227 NSS. (no corrosion)
 - Color: brown-black

SZCZEGÓŁ A. 2:1

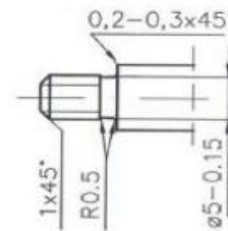

SZCZEGÓŁ B. 2:1

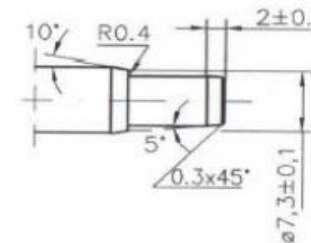

SYMBOL	Ilość charakterystyk
SYMBOL	No characteristic
<DP>	-
<DC>	-
<D>	-
<C+>	-
<+>	2

TOLERANCJE WYMIARÓW METROLOGICZNYCH WZGLĘDNYMI

(ISO 2768 : 89)
PN-EN-22768: 99-mK

MATERIAL: ROUND STEEL Material grade C35E acc. to EN 10083-2			METODA RZUTOWANIA 		Intelli CAD
WYKONAL TOMASZ KŁATKA	DATA 29.09.2020	CHARAKT. SPECJALNE	NAZWA: Piston rod		
ZATWIERDZIŁ [Signature]	DATA 29.09.2020		NR RYSUNKU: M27281		NR INDEKSU acc. table
FORMAT: A2	MASA: [] kg	<+>			
PODZIAŁKA: 1:1					

mm 0 10 20 30 40

零件号PN	规格Size	全长	行程L	图纸号
M27281	8	261.8	243.5	M27281
M27336	8	271.8	253.5	M27281
M27406	8	238.8	220.5	M27281
M27410	8	212.8	194.5	M27281
M27414	8	142.8	124.5	M27281
M27419	8	294.8	276.5	M27281
M27440	8	284.8	266.5	M27281
M27521	8	162.8	144.5	M27281
M27522	8	202.8	184.5	M27281
M27550	8	157.8	139.5	M27281
M27561	8	242.8	224.5	M27281
M27568	8	278.8	260.5	M27281
M27577	8	222.3	204	M27281
M27599	8	274.8	256.5	M27281
M27609	8	251.8	233.5	M27281
M27615	8	292.8	274.5	M27281
M27621	8	297.8	279.5	M27281
M27626	8	352.8	334.5	M27281
M27627	8	152.8	134.5	M27281
M27785	8	318.8	300.5	M27281
M27809	8	368.8	350.5	M27281
M27813	8	216.3	198	M27281
M27818	8	234.8	216.5	M27281
M28073	8	192.8	174.5	M27281
M28378	8	57.8	39.5	M27281
M28719	8	229.8	211.5	M27281
M28720	8	254.8	236.5	M27281
M28721	8	245.3	227	M27281
M28722	8	224.8	206.5	M27281
M28723	8	247.8	229.5	M27281