

The print-out is not subject to the modification service.

Intended for internal and supplier use

Ersteiltdatum: 7/7/2021 - 8:3

Ident. Doc.:

supp No.	material no.		A	E
	processing and surface treatment acc. to STAB-Spec. 10006248 Tab. XVI (a) version 1	10028959 Tab. I (b) version 2	overall length	length without endfitting stud
1	956036	956036	252.0	242.5
2	956275	956275	255.0	245.5
3	886968	886968	300.0	290.5
4	490468	490468	111.0	101.5
5	111416	111416	192.0	182.5
6	674504	674504	194.0	184.5
7	164957	164957	243.0	233.5
8	907530	907530	202.0	192.5
9	072465	072465	264.0	254.5
10	077723	077723	336.0	326.5
11	078918	078918	266.0	256.5
12	091824	091824	265.0	255.5
13	096604	096604	137.0	127.5
14	097082	097082	148.5	139.0
15	101145	101145	147.0	137.5
16	110466	110466	154.0	144.5
17	111900	111900	165.0	155.5
18	113095	113095	139.0	129.5
19	121938	121938	90.0	80.5

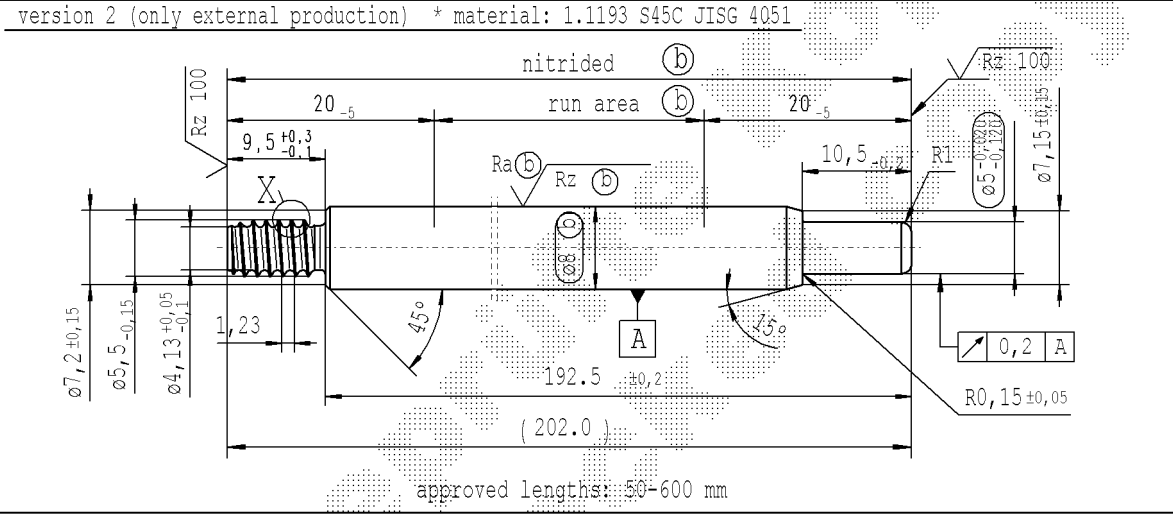
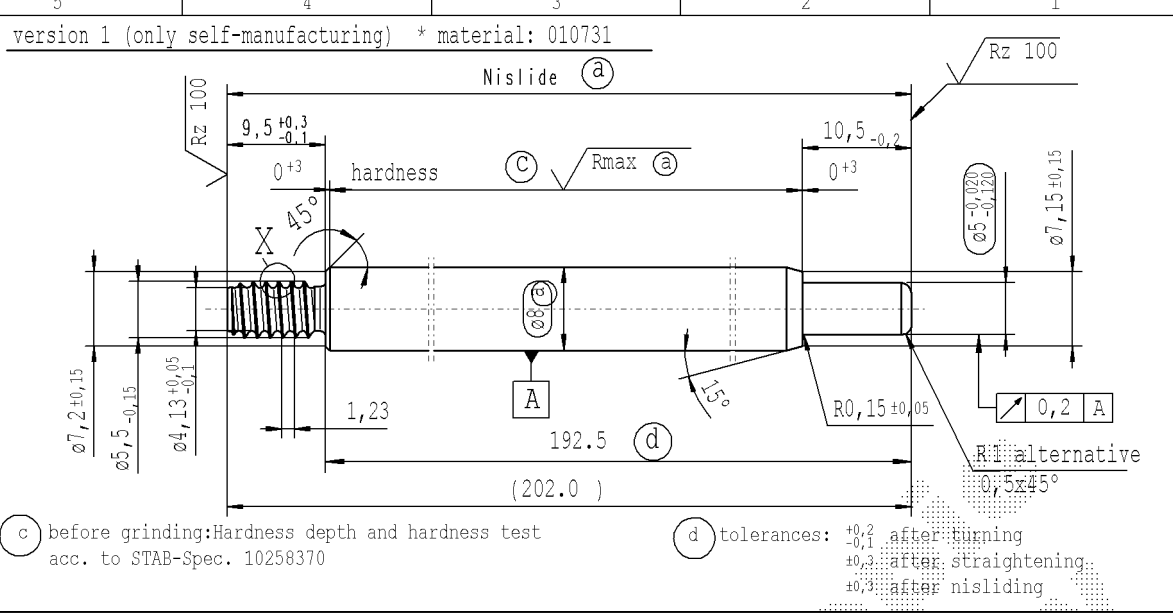

pre-worked: (only self-manufacturing)

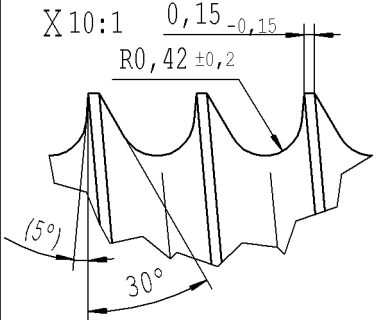
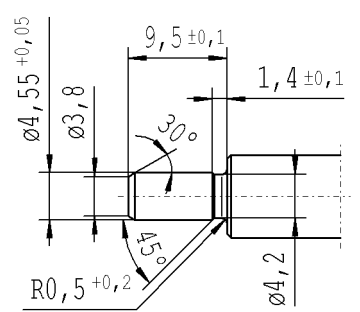

sheet 1 of 5

AIAG CQI-standards acc. to STAB-Spec. 10027692						Environmental protection acc. to STAB-Spec. 10005649						
DE: X	EN: X	ES:	IT:	PR: X	FR:	RO: X	Material:	All dimensions are in mm	Marking of special characteristics according to STAB-Spec. 10270932	Drawn by	Date	Name
new	no technical change, no new first sample required					(5°) no technical change, no new first sample required				Checked	01.06.2018	Höfer
old	Tab IV					5°	Edge tolerances acc. to DIN ISO 13715	Scale: (Original DIN A3) 2:1	Dimensions without tolerances DIN ISO 2768-mK			
Field	C-F 8					B/6-7	Surface finish acc. to DIN EN ISO 1302	We reserve all rights to this document, to any patents or patent registrations related hereto, and to the duplication, retransmission by third parties and misc. use. Any use of this document is not permitted without the written consent of STABILUS.				
Date/Name	16.12.2020 Hein					08.04.2021 Hein	Reguliertes:	Document No.: 10254976				
Chg. No.	693200					696948		Material No.:				
Rev.	3					3	<b>STABILUS</b>	<b>PISTON ROD</b>				