

The print-out is not subject to the modification service.

Intended for internal and supplier use

EN

Ident. Doc.:

Date/Name

No.	material no.			A	B	C
	processing and surface treatment acc. to STAB-Spec.: 10006248 Tab. IV	10006248 Tab. X	10028959 Tab. I			
	(a) version 1	(a) version 1	(b) version 2	overall length	stud length end-fitting side	clearance dim. groove
1		375040	375040	323.5	15	12.2
2		375996	375996	332.5	15	12.2
3		376474	376474	336.5	15	12.2
4		839182	839182	227.5	25	22.5

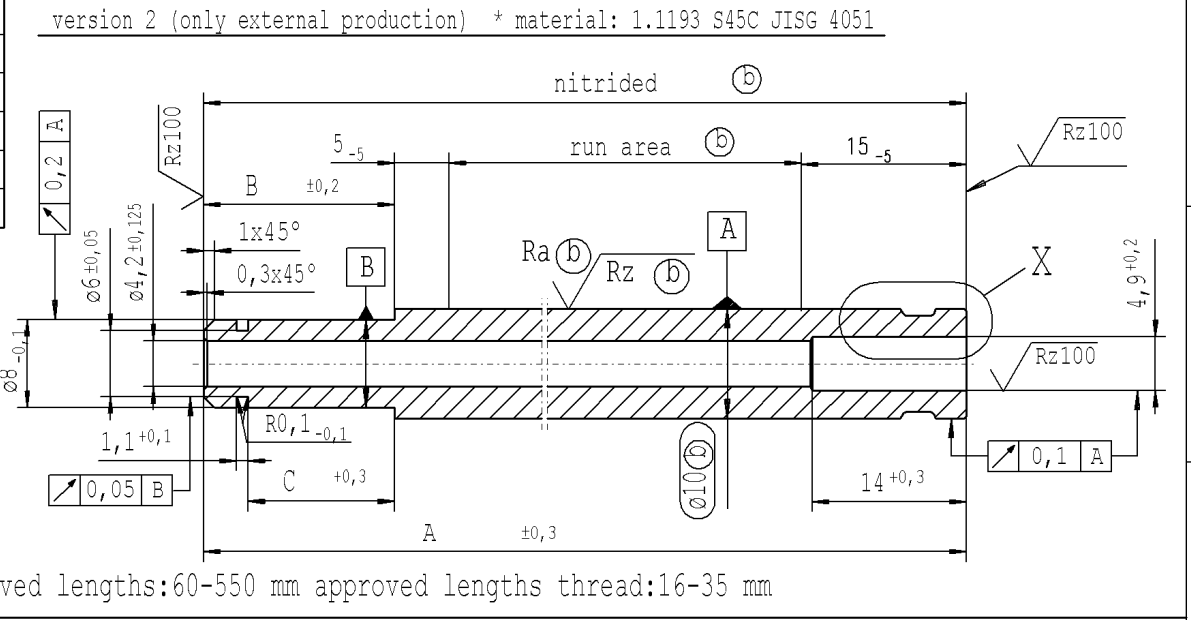
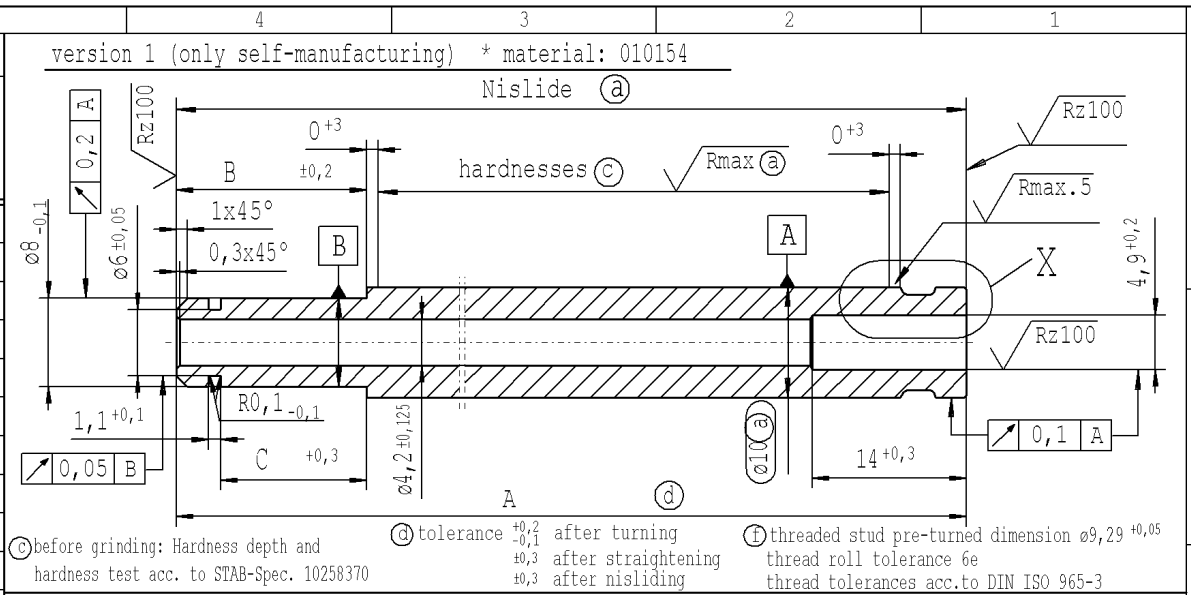

100% cleanliness of through hole

Rz 25 (Rz 100 Rmax5 Rmax (a) Ra (b) Rz (b)) $+0,2$ $-0,2$ $\pm 0,1$

sheet 1 of 1

X pre-worked: (only self-manufacturing)

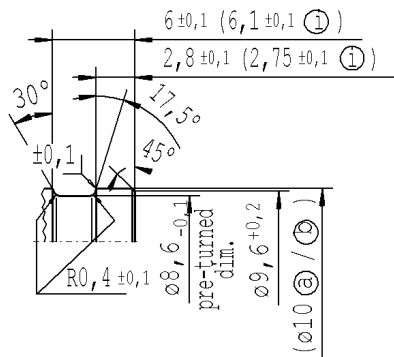

X Control dimension! 100% visual checking

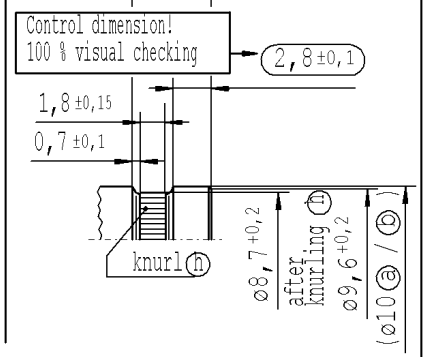

AIAG CQI-standards acc. to STAB-Spec. 10027692						
DE: X	EN: X	ES:	IT:	PR:	FR:	RO: X
CAD created document; handwritten changes not permitted						
new	INITIAL RELEASE					
old	-					
Field	-					
Date/Name	05.07.2021 Hein					
Chg. No.	699939					
Rev.	0					

Environmental protection acc. to STAB-Spec. 10005649		
Material: *	All dimensions are in mm	Marking of special characteristics according to STAB-Spec. 10270932
Edge tolerances acc. to DIN ISO 13715	Scale: (Original DIN A3) 2:1	Dimensions without tolerances DIN ISO 2768-mK
Surface finish DIN EN ISO 1302	We reserve all rights to this document, to any patents or patent registrations related hereto, and to the duplication, retransmission by third parties and misc. use. Any use of this document is not permitted without the written consent of STABILUS.	
Replaces:	Document No.: 10294942	
STABILUS	PISTON ROD	
	Material No.:	