

The print-out is not subject to the modification service.

Intended for internal and supplier use

EN

Ident. Doc. :
Date: 17/5/2022 - 14:29

No.	material no.			A
	version 1	version 1	version 2	
1	196507	196507	196507	267
2	593011	593011	593011	334
3	595162	595162	595162	213
4	595640	595640	595640	132
5	596118	596118	596118	258
6	596596	596596	596596	384
7	609741	609741	609741	276
8	697454	697454	697454	117
9	718964	718964	718964	174
10	850653	850653	850653	147
11	893195	893195	893195	260
12	919485	919485	919485	345
13	923070	923070	923070	123
14	993097	993097	993097	255
15	081552	081552	081552	354

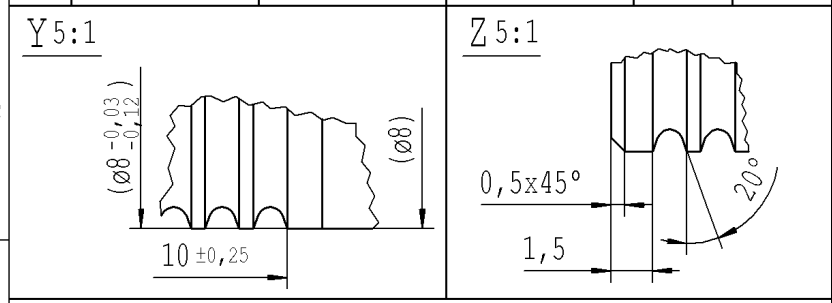

(c) before grinding:
Hardness depth and hardness test acc. to STAB-Spec. 10258370

(d) tolerance $\begin{matrix} +0,2 \\ -0,1 \end{matrix}$ after turning
 $\begin{matrix} +0,3 \\ -0,3 \end{matrix}$ after straightening
 $\begin{matrix} +0,3 \\ -0,3 \end{matrix}$ after chroming/nisliding

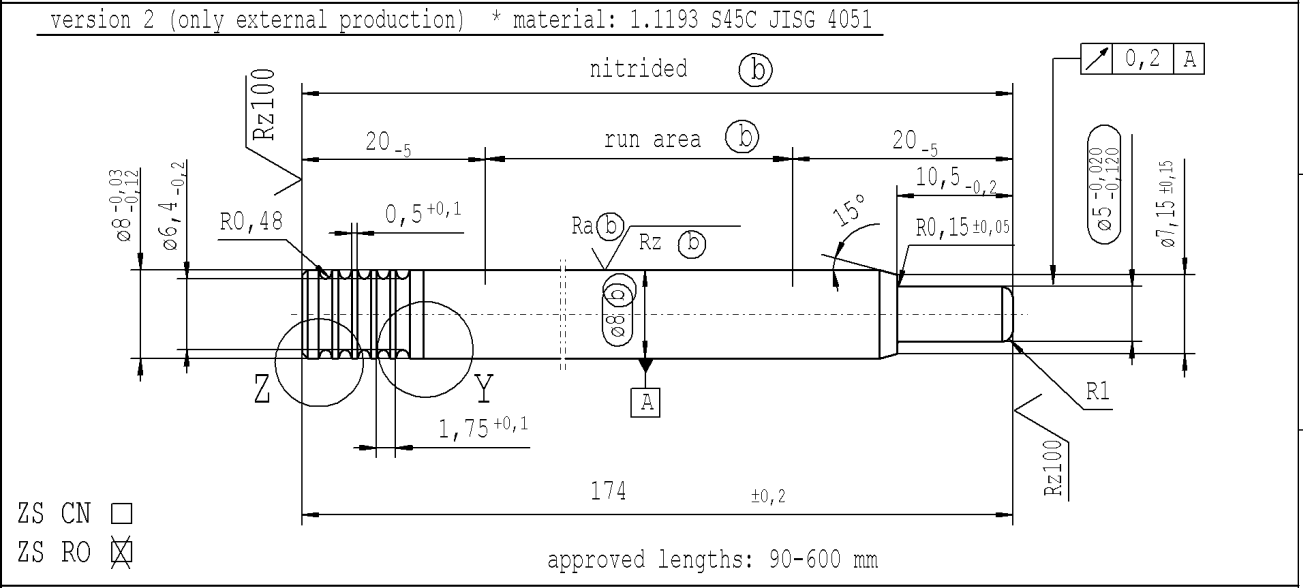
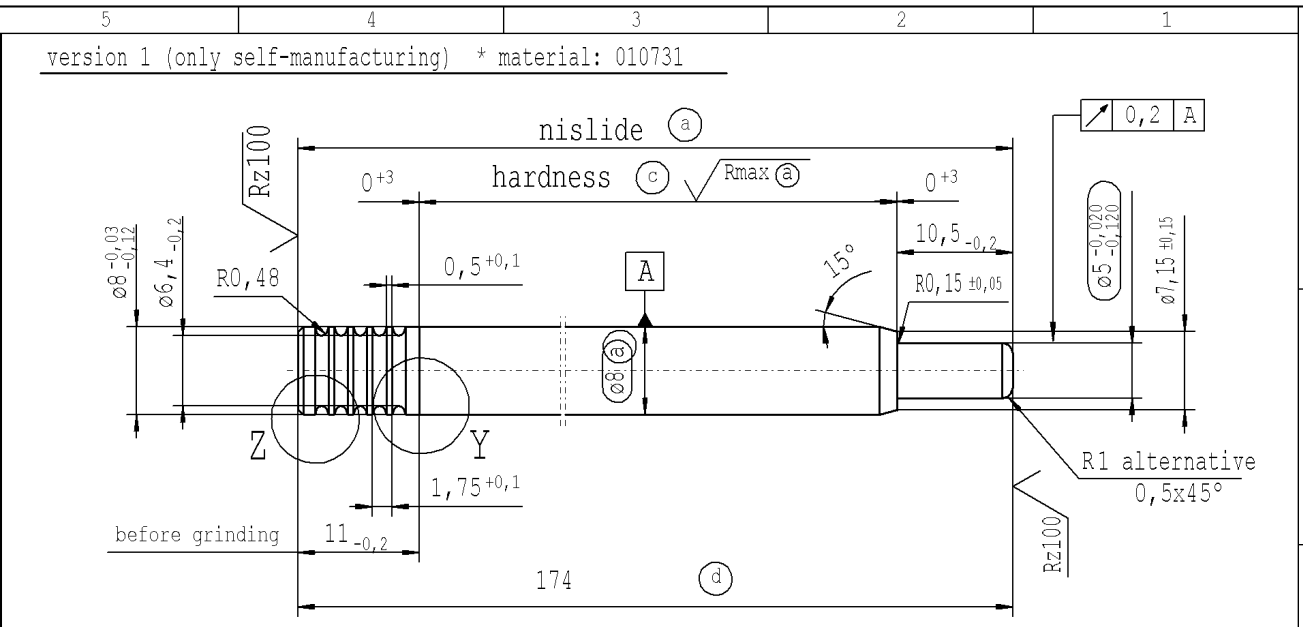

ZS CN
ZS RO

$\sqrt{Rz\ 25}$ ($\sqrt{Rz\ 100}$ $\sqrt{Rmax\ (a)}$ $Ra\ (b)$ $Rz\ (b)$) $\begin{matrix} +0,2 \\ -0,2 \end{matrix}$

sheet 1 of 1

AIAG CQI-standards acc. to STAB-Spec. 10027692							Environmental protection acc. to STAB-Spec. 10005649										
DE: X	EN: X	ES:	IT:	PR:	FR:	RO: X	CAD created document handwritten changes not permitted			Material: *	All dimensions are in mm		Marking of special characteristics according to STAB-Spec. 10270932		Date	Name	
new	INITIAL RELEASE			ZS CN / ZS RO no technical change, no new first sample required						Edge tolerances acc. to DIN ISO 13715	Scale: (Original DIN A3) 2:1		Dimensions without tolerances DIN ISO 2768-mK		Drawn by	Hein	
old	-			-						Surface finish DIN EN ISO 1302			Checked	14.04.2022	Klinkner		
Field	-			B/5						Replaces:			Document No.:		10293697		
Date/Name	11.05.2021 Hein			14.04.2022 Hein										Material No.:			
Chg. No.	-			709727													
Rev.	0			0													
							STABILUS					PISTON ROD					