

The print-out is not subject to the modification service.

Intended for internal and supplier use

EN

BrevéLidatum: 10/12/2023 - 9:10

Ident. Doc.:

supp No.	material no.			A	B
	processing and surface treatment acc. to STAB-Spec.: 10006248 Tab. IV (a) version 1	10006248 Tab. X (a) version 1	10028959 Tab. I (b) version 2	overall length	stud length end-fitting side
241	591819	591819		113.5	40
242	165683	165683		308.5	16
243	170463	170463		179.5	32
244	174526	174526		212.5	20
245	188627	188627		66.5	24
246	190061	190061		69.0	24
247	191495	191495		77.5	24
248	195797	195797		212.5	18
249	196514	196514		83.5	24
250	196992	196992		312.0	16
251	206552	206552		365.5	18
252	207030	207030		419.5	16
253	207508	207508		317.5	18
254	207986	207986		56.5	22
255	208464	208464		269.5	16
256	217546	217546		218.5	20

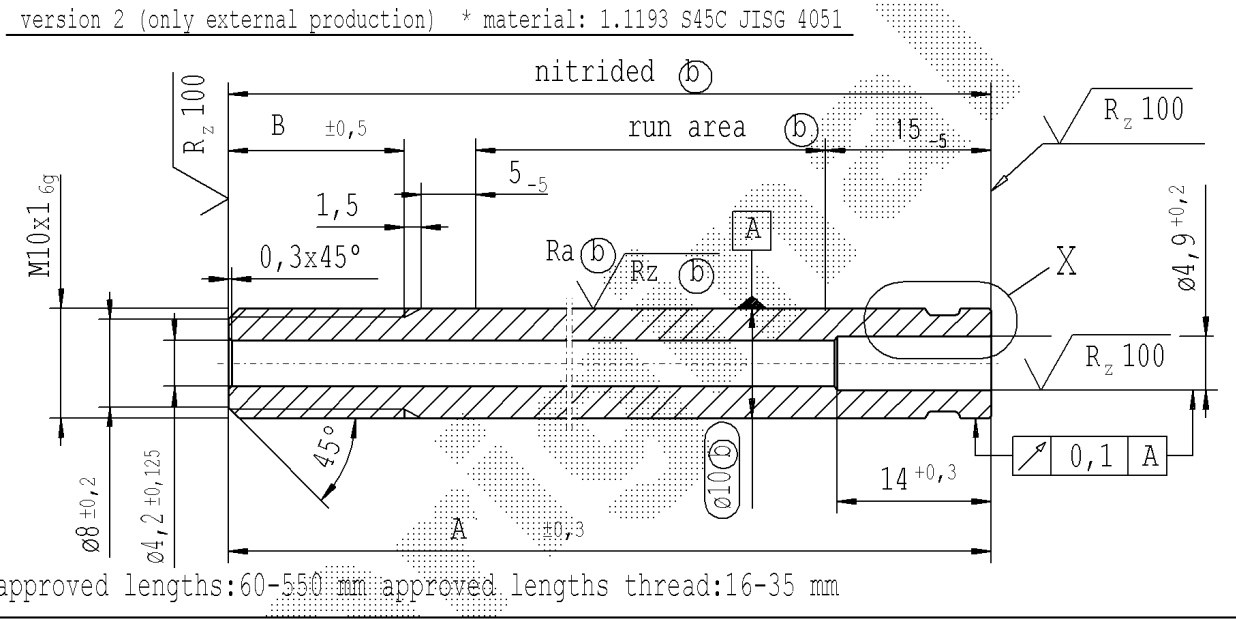
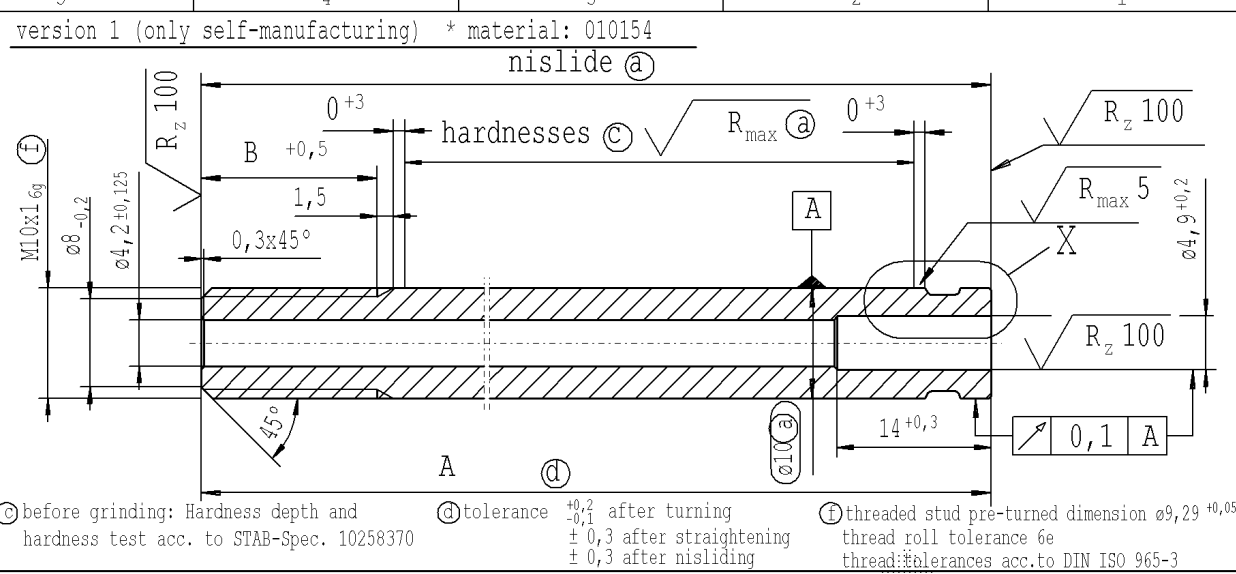

100% cleanliness of through hole

$R_z 25$  ( $\sqrt{R_z 100}$   $\sqrt{R_{max} 5}$   $\sqrt{R_{max} (a)}$   $R_a (b)$   $R_z (b)$ )  $+0,2$   $-0,2$   $\pm 0,1$

sheet 16 of 17

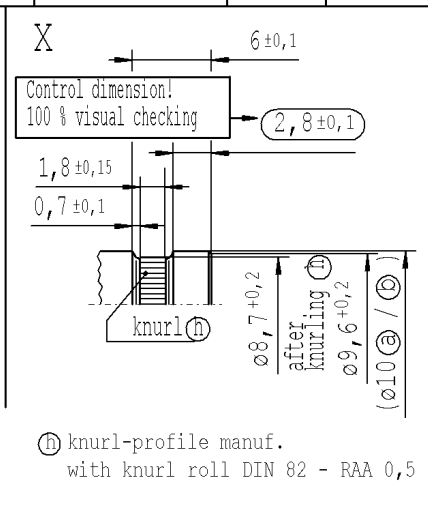
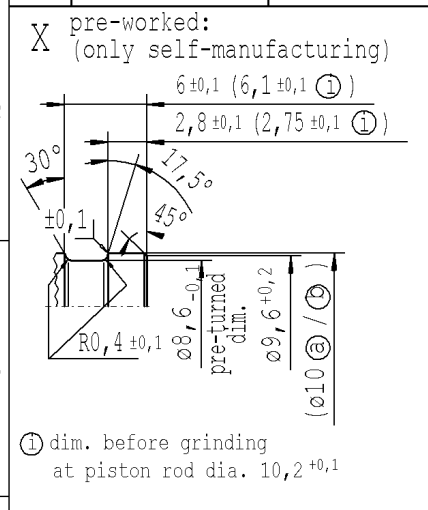

AIAG CQI-standards acc. to STAB-Spec. 10027692				Environmental protection acc. to STAB-Spec. 10005649								
DE: X	EN: X	ES:	IT:	PR:	FR:	RO: X	CAD created document; handwritten changes not permitted	Material: *	All dimensions are in mm	Marking of special characteristics according to STAB-Spec. 10270932	Date	Name
new	thread roll tolerance 6e	③ = acc. STAB-Spec. 10258370					new format Internal/Supplier	B $\pm 0,5$	Scale: (Original DIN A3) 2:1	Dimensions without tolerances DIN ISO 2768-mK	Drawn by	Höfer
old	thread roll tolerance 6g	④ = RHT 0,4 ... 0,7 mm					Supplier drawing separately	B $\pm 0,5$			Checked	Tilea, M.
Field	B8				C 7-8		-	D/4			Document No.:	10152095
Date/Name	16.06.2015 Donat				15.05.2019 Donat		25.06.2021 Jablonski	24.02.2022 Hein			Material No.:	
Chg. No.	639400				678703		698250	707230				
Rev.	6				7		8	9				
								<b>STABILUS</b>	<b>PISTON ROD</b>			