

CONFIDENTIAL!
Intended for internal use only

supp. No.	material no.			A overall length	B stud length	C threads length thread-on-bar	D threads length plus run-out	E length without end-fitting stud
	surface treatment processing acc. to STAB-Spec. 10006248, Nislid Tab. IV	Nislid Tab. X	table XVI Nislid black					
1	7256NH	4496VP		203	18	5	7	194.5
2	6255QI		6255QI	166	18	5	7	157.5
3	5731UY		5731UY	235	19.5	7	8.5	226.5
4	013780			267	18	5	7	258.5
5	019647			102	18	5	7	93.5
6	552335			174	19.5	7	8.5	165.5
7	538236			93	19.5	7	8.5	84.5
8		945972		128	18	5	7	119.5
9		822651		192	18	5	7	183.5
10	644357			142	18	5	7	133.5

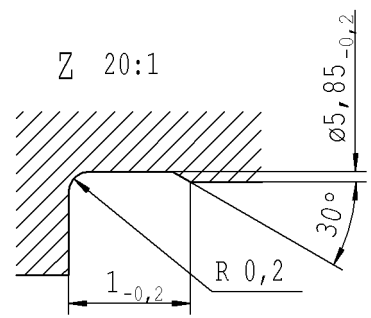

- Ⓐ piston rod processing acc. to STAB-Spec. 10006248
- Ⓑ before grinding: Hardness depth and hardness test acc. to STAB-Spec. 10258370
- Ⓒ tolerance $+0,2$ after turning $\pm 0,3$ after straightening $\pm 0,3$ after nisliding
- Ⓓ threaded stud rough-turned dimension $\varnothing 5,29_{-0,06}$ thread roll tolerance 6e acc. to DIN ISO 965-3

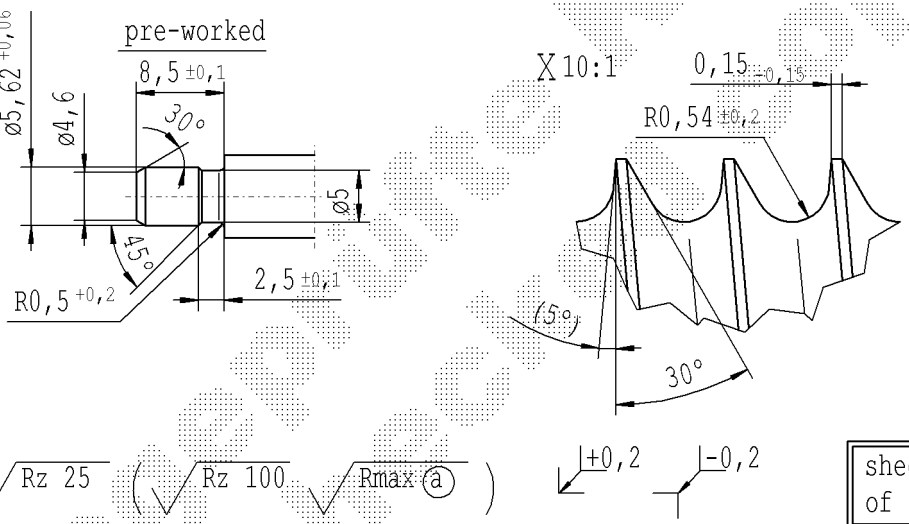
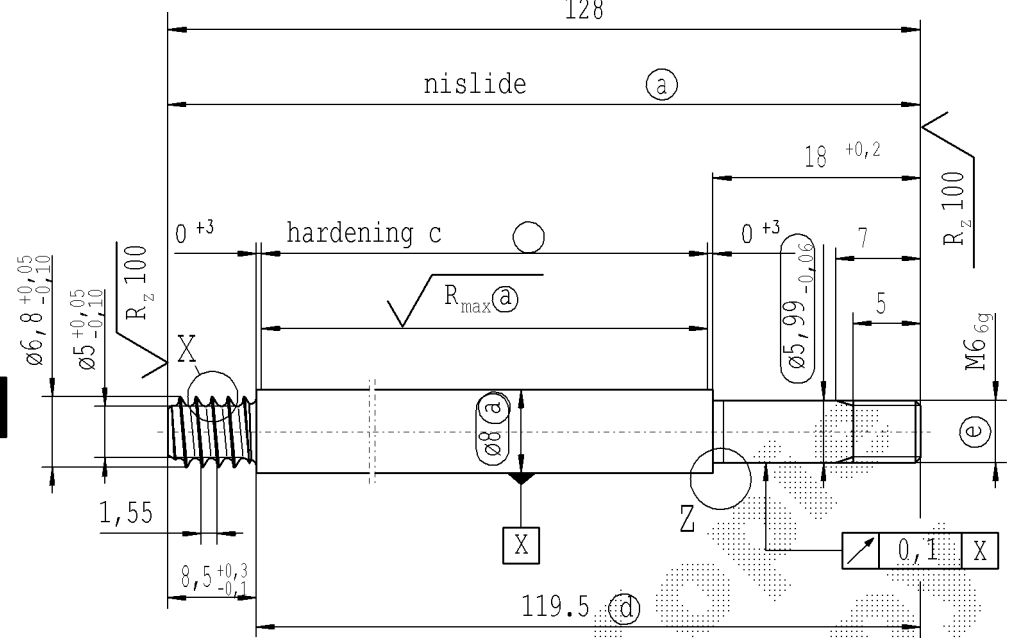

sheet 1
of 2

Environmental protection acc. to STAB-Spec. 10005649

Ident. Doc.: 22/07/2023 - 10:30

DE: X	EN: X	ES:	IT:	PR:	FR:	RO: X	CAD created document handwritten changes not permitted			
new	Tab. XVI		rom. version created		position of angle 5° corrected 8,5 $+0,1$ $-0,1$		Ⓒ = acc. STAB-Spec. 10258370		(5°)	
old	-		-		wrong position of angle 5° (8,5)		Ⓒ = RHT 0,4 ... 0,7 mm		(8°)	
Field	-		-		B-C/1-2 D/4		B 7-8		B/2-3	
Date/Name	20.11.2015 Kievernagel		27.04.2016 Jablonski		08.03.2019 Hein		14.05.2019 Jablonski		22.04.2021 Hein	
Chg. No.	631024		637364		675165		678534		696949	
Rev.	8		9		10		11		12	

Material: mat. no. 010731

Edge tolerances acc. to DIN ISO 13715

Surface finish acc. to DIN EN ISO 1302

Registries:

STABILUS

All dimensions are in mm

Scale: (Original DIN A3) 2:1

Dimensions without tolerances DIN ISO 2768-mK

We reserve all rights to this document, to any patents or patent registrations related hereto, and to the duplication, retransmission by third parties and misc. use. Any use of this document is not permitted without the written consent of STABILUS.

PISTON ROD

Marking of special characteristics according to STAB-Spec. 10270932	Date	Name
Drawn by	04.05.2000	Bo.
Checked	22.04.2021	Klinkner
Document No.:	10013860	
Material No.:		