

CONFIDENTIAL!
Intended for internal use only

supp. No.	material no.				A	B
	surface treatment processing acc. to STAB-Spec. 10006248					
	table IV Nislide black	table VIII Nislide black	table V Nislide light	table X Nislide "G"		
188				451482	164.5	16
189				476577	374.5	16
190				788710	502.0	16
192	070278				598.5	16
193				346562	98.5	18
195				717968	260.5	16
196				856110	185.5	16
198				184760	62.5	16
199			947170		401.5	18
200				079362	170.5	16
201	325771				451.5	16
203			403446		455.5	18
204		958643			493.5	18
206				714386	401.5	16
207				305458	167.5	18
208	797795				362.5	16
209				575528	206.5	20
210				746174	470.5	16
211				462244	143.5	16
214	891488				463.5	16
215				893161	202.5	16

Permanent additional inspection 008/13
valid only for w/* marked Material No.

STAB	STES	STGB	STIT	STAU	STUS	STVZ	STWZ	STXZ	STYX
------	------	------	------	------	------	------	------	------	------

100% Check concentricity thread M8x1
Test equipment coil cradle with dial gauge
! Caution using flat peak measuring!
Concentricity tolerance:
acc. to DIN ISO 2768-mK > 0,2 mm

100% cleanliness of through hole

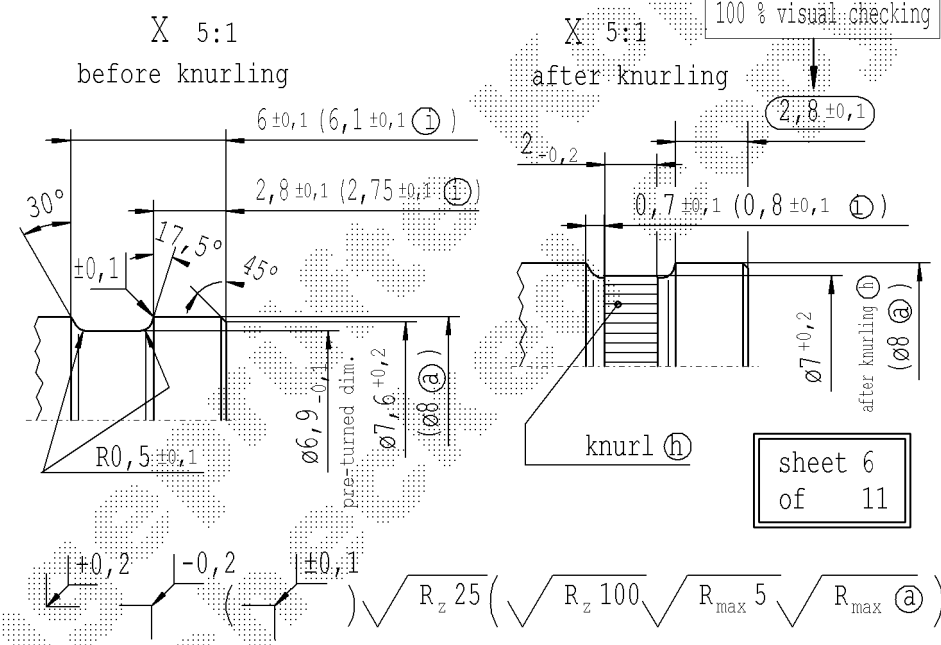
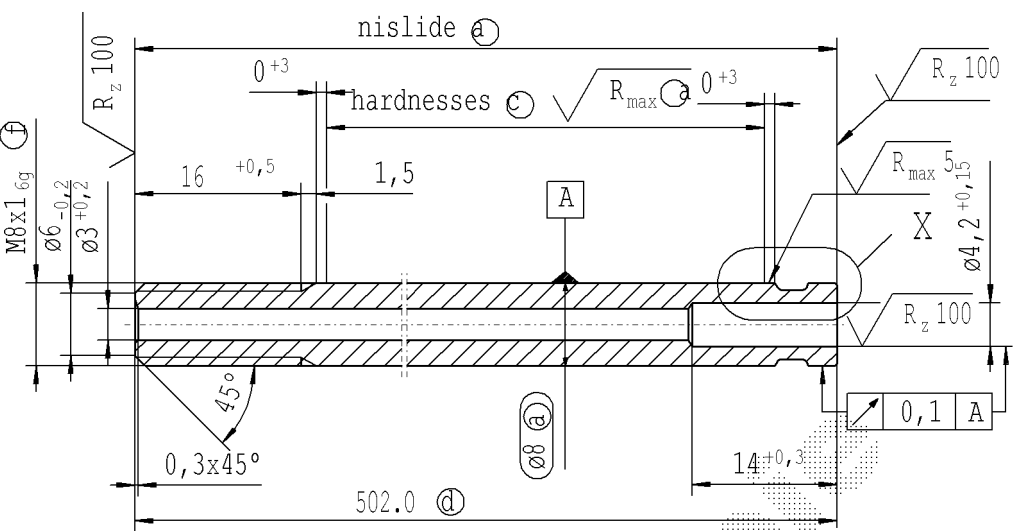

- a) piston rod processing per STAB-Spec. 10006248
- b) before grinding: Hardness depth and hardness test acc. to STAB-Spec. 10258370
- c) tolerance: +0.1 before thread-rolling, -0.2 after thread-rolling, +0.3 after straightening, +0.3 after nisliding
- d) threaded stud pre-turned dim. $\phi 7,30_{-0,06}$ thread roll tolerance 6e thread tolerances acc. DIN ISO 965-3
- e) knurl-profile manufactured with knurl roll DIN 82 - RAA 0,5
- f) dims. before grinding for piston rods $\phi 8,35_{-0,11}$

sheet 6 of 11

Environmental protection acc. to STAB-Spec. 10005649

Ident. Doc.: SN 6742BA

DE: X	EN: X	ES: X	IT:	PR:	FR:	RO: X	CAD created document handwritten changes not permitted			Material:	All dimensions are in mm		Marking of special characteristics according to STAB-Spec. 10270932		Date	Name
new	Permanent additional inspection 014/01			C = acc. STAB-Spec. 10258370			100% cleanliness of through hole			mat.no. 010146	Scale: (Original DIN A3) 2:1		Dimensions without tolerances DIN ISO 2768-mK		26.01.1994	Kornely
old	Temporary additional inspection 014/01			C = RHT 0,4 ... 0,7 mm			Permanent additional inspection 014/01			Edge tolerances acc. to DIN ISO 13715	We reserve all rights to this document, to any patents or patent registrations related hereto, and to the duplication, retransmission by third parties and misc. use. Any use of this document is not permitted without the written consent of STABILUS.		Checked		26.04.2022	Milles
Field	C-D 5			B 7-8			D/4-5			Surface finish DIN EN ISO 1302	Registries:		Document No.:		10004290	
Date/Name	25.03.2019 Höfer			10.05.2019 Jablonski			09.06.2021 Hein			SN 6742BA			Material No.:			
Chg. No.	671363			678466			677895			STABILUS			PISTON ROD			
Rev.	32			33			34									