

CONFIDENTIAL!  
Intended for internal use only

supp.	material no.			A	B	C	D	E	F
No.	surface treatment processing acc. to STAB-Spec. 10006248			overall length	stud length	threads= length	threads= length	threads= length	version
	Nislide Tab. IV	without surface treatment	table XVI Nislide black			length thread-on= bar	length plus run-out	length end stop-sided	
27	632416	639108		123.5	18	5	7	8	1
28	152746		152746	114.0	18	5	7	10	1
29	379564			93.0	19.5	7	8.5	20	1
30	209158			147.0	18	5	7	15	1
31	529181			192.0	19.5	7	8.5	25	2
32	850875			132.0	18	5	7	12	1
33	087989			102.0	18	5	7	12	1
34	923792			180.0	20	6.5	8.5	12	1

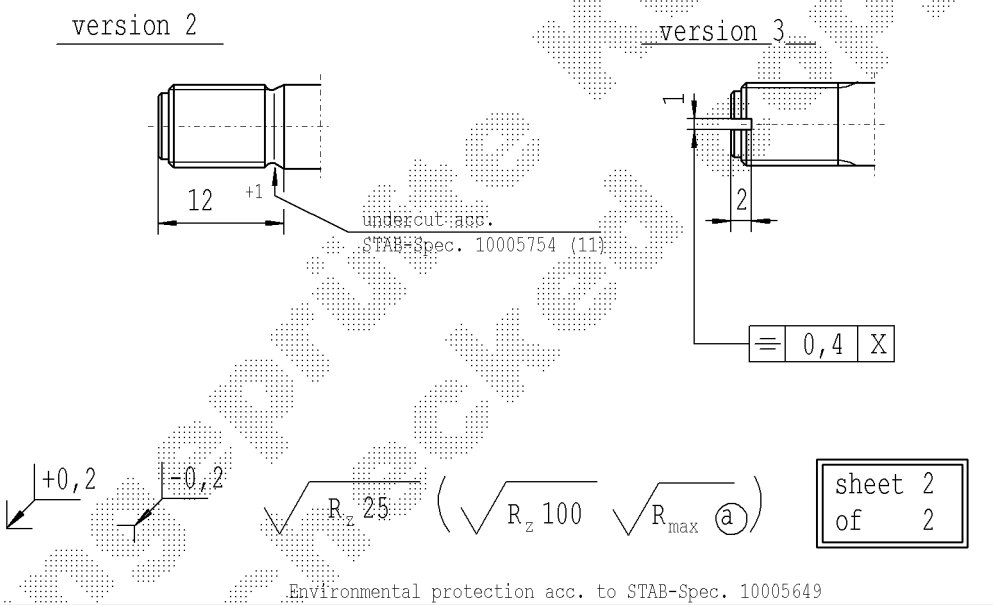

- Ⓐ piston rod processing acc. to STAB-Spec. 10006248
- Ⓑ before grinding: Hardness depth and hardness test acc. to STAB-Spec. 10258370
- Ⓒ tolerance  $\pm 0,1$  after turning  $\pm 0,3$  after straightening  $\pm 0,3$  after nisliding
- Ⓓ threaded stud rough-turned dimension  $\phi 5,29_{-0,06}$  thread roll tolerance 6e acc. to DIN ISO 965-3
- Ⓕ threaded stud rough-turned dimension  $\phi 7,14_{-0,06}$  thread roll tolerance 6e acc. to DIN 965-3

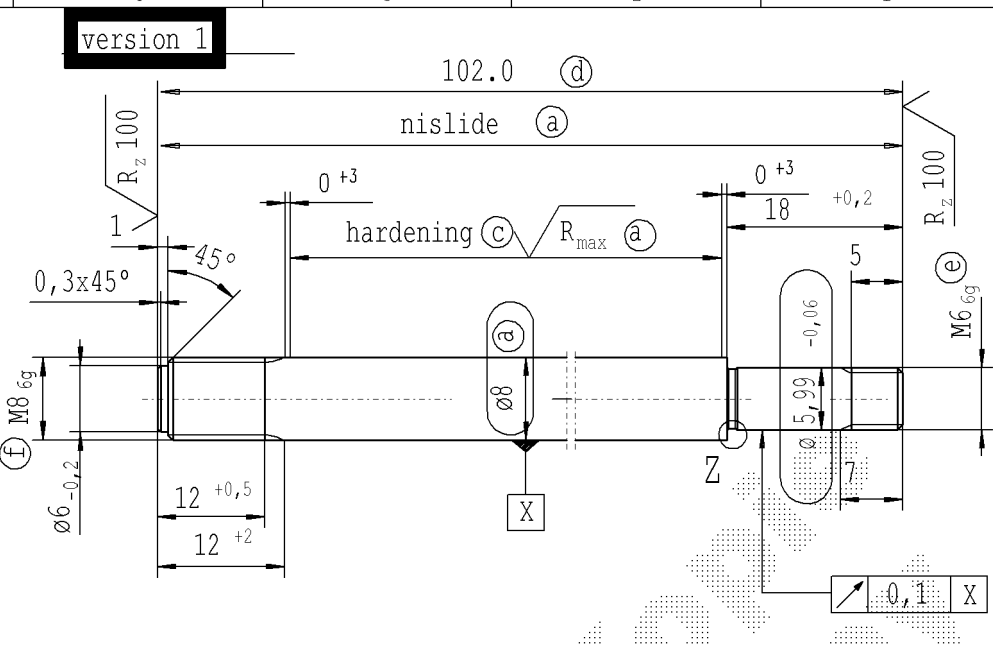
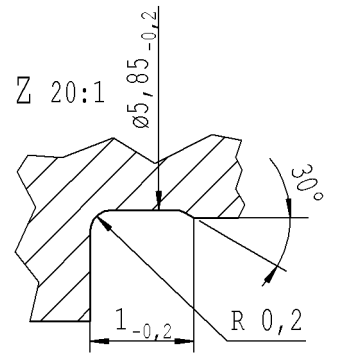

Environmental protection acc. to STAB-Spec. 10005649

DE: X	EN: X	ES:	IT:	PR:	FR:	RO: X	CAD created document handwritten changes not permitted							
new	D=8,5			Reworked		without surface	Tab.XVI	rom. version created	Ⓒ = acc. STAB-Spec. 100056370	mat.no. 010731				
old	D=8,0			-		-	-	-	Ⓒ = RHT 0,4					
Field	supp.no.1,2,3,4,8,12			-		Tab.	-	-	B 7-8					
Date/Name	05.09.02 Bo.			20.07.2004 Schönberger		05.08.2015 Höfer	21.10.2015 Höfer	28.06.2016 Jablonski	02.05.2019 Donat					
Chg. No.	522926			538112		626906	629806	640401	678231					
Rev.	9			10		11	12	13	14					

Material:	All dimensions are in mm	Identification of important characteristics	Drawn by	Date	Name
mat.no. 010731	Scale: (Original DIN A3) 2:1	Dimensions without tolerances DIN ISO 2768-mK	Checked	16.09.1992	R.
Edge tolerances acc. to DIN ISO 13715	We reserve all rights to this document, to any patents or patent registrations related hereto, and to the duplication, retransmission by third parties and misc. use. Any use of this document is not permitted without the written consent of STABILUS.		Document No.:		
Surface finish acc. to DIN ISO 1302			10002405		
Regulations: SN 51.11-08/56			Material No.:		
<b>STABILUS</b>	<b>PISTON ROD</b>				